

ELECTRONIC CABINET LOCKS

PRECISION MADE IN AUSTRIA

www.pslocks.com

CONTENT

About PS GMBH	3
SOLO	5
TEN	10
TWO	13
PLUR	16
QUAD	20
MINI	24
FLIN	27
PAD II	31
BEETLE	34
Accessories	37
Programming	44

ABOUT PS GMBH

Since 1986, PS GmbH has been recognized as a reliable supplier and wholesaler of furniture components.

PS got worldwide market leader in the field of innovative and high-precision electromechanical locks in the high-end furniture sector.

Our solutions are very easy to install, simple to program and useful in many indoor applications.

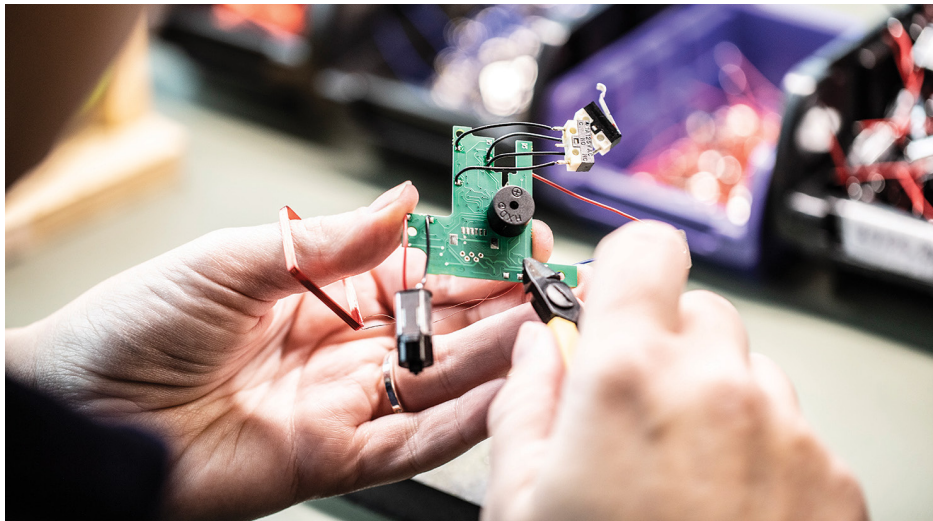

PRODUCTION

With a brand new building the whole production and development moved back to Austria in the year 2012. Our product range includes options from RFID to Bluetooth to simple electromechanical locks.





QUALITY

PS strives to provide customers with high-quality products and excellent customer service as well as fast lead times.

PS will continue to do our very best, every day, to ensure you are confident in our services and get exactly what you need.

5-YEAR WARRANTY

Rely on the service and the quality of the PS products which come with a 5-year warranty. Benefit from the security, guaranteed to receive reliable support!



THE FEDERAL COMMUNICATIONS COMMISSION

This device complies with part 15 of the FCC rules. Operation is subject to the following two conditions: 1.This device does not cause harmful interference, and 2.This device accepts any interference received including interference that may cause undesired operation.

This product has to be used according to instructions provided with the shipment. Any change of assemblage, technology or installation is not permitted. PS guaranties to fulfill the FCC rules based on the FCC certification.

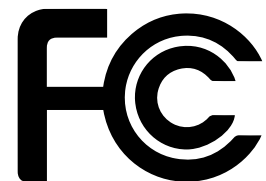

SOLO

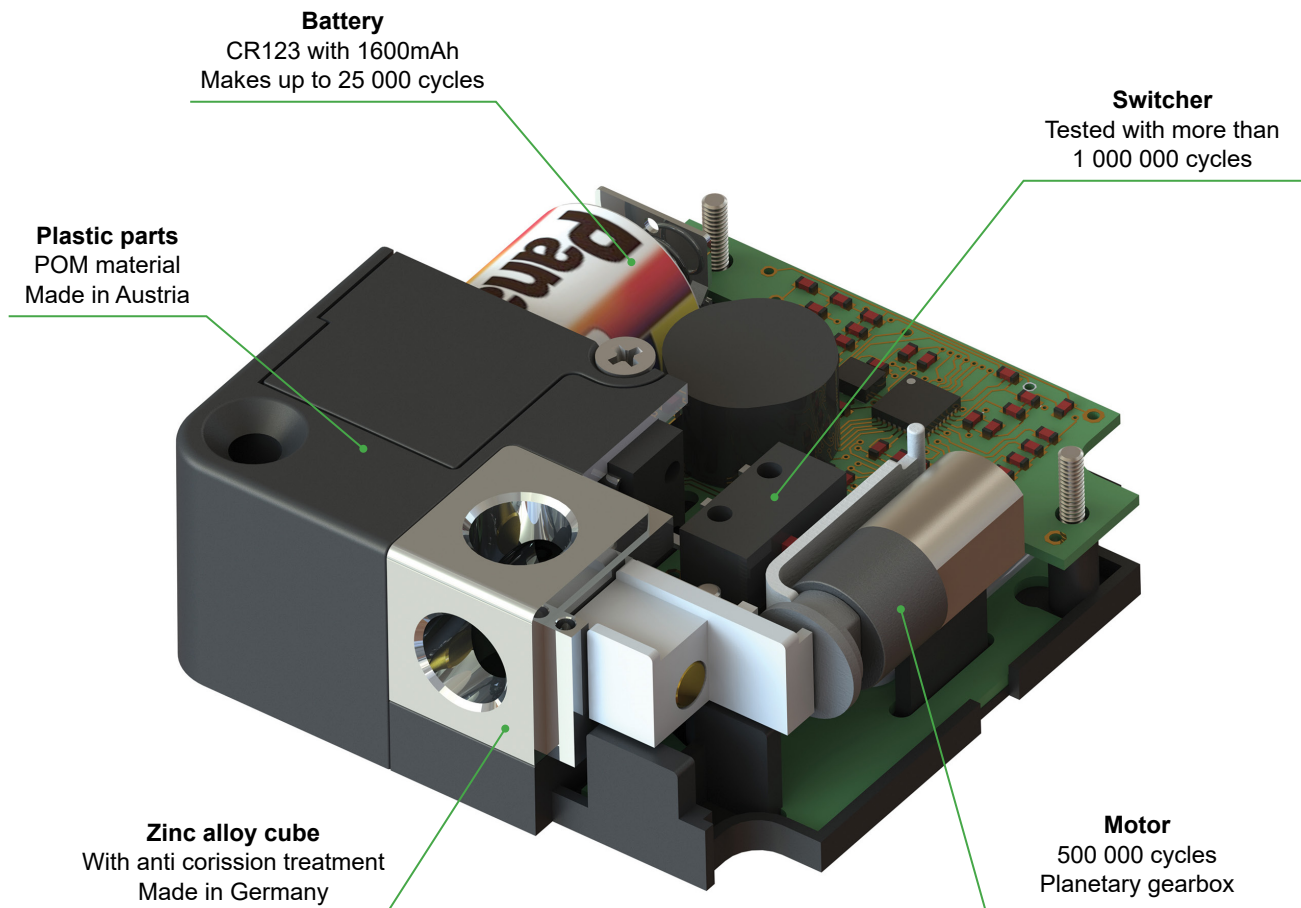

Doors

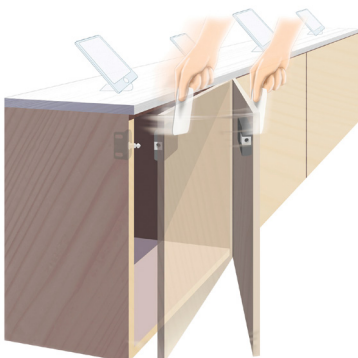

Drawers



Slidingdoors

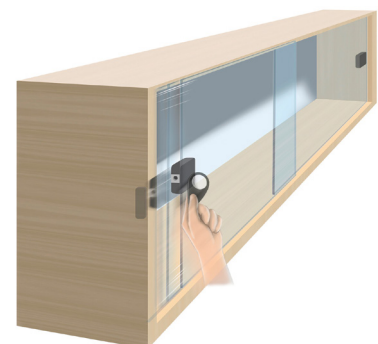

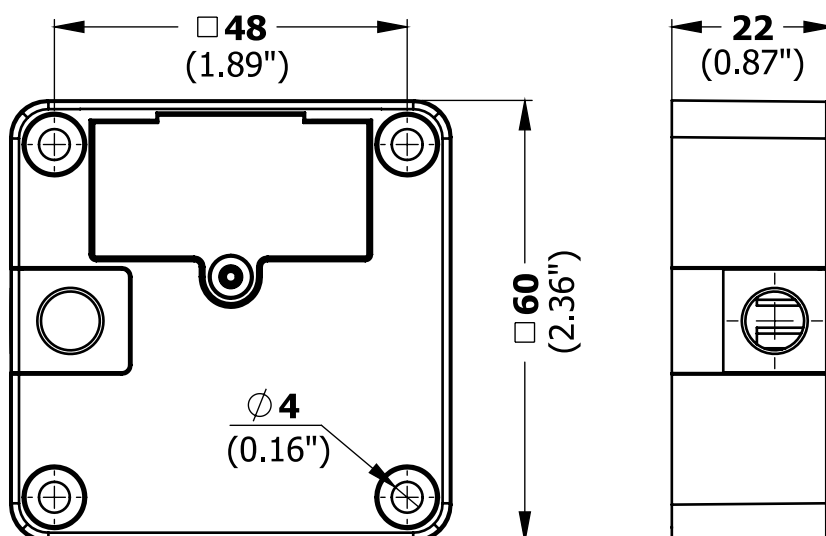

Doors

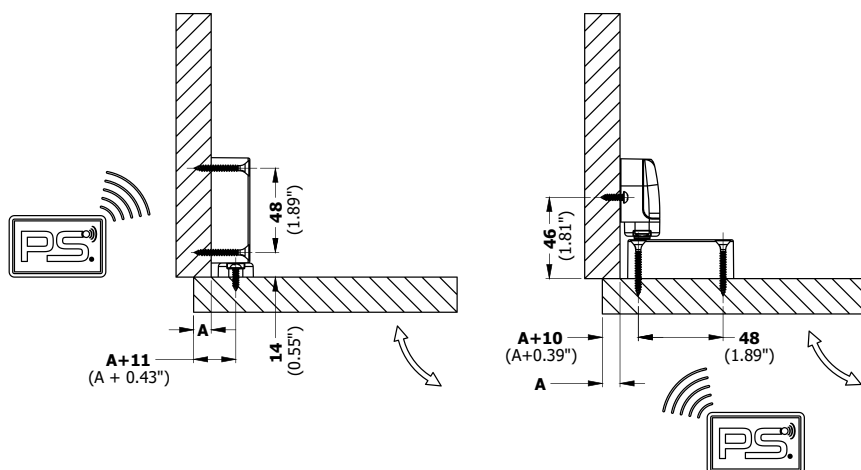
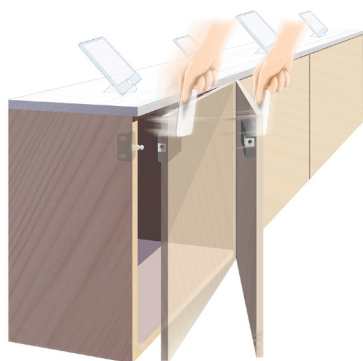

Drawers

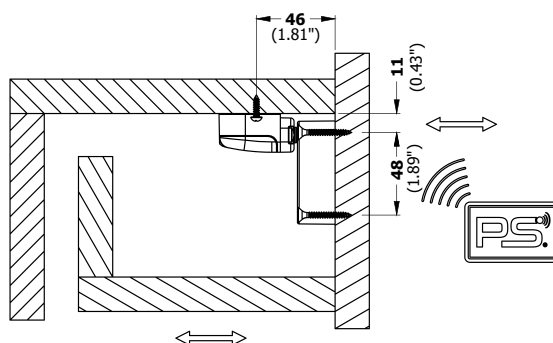

Slidingdoors

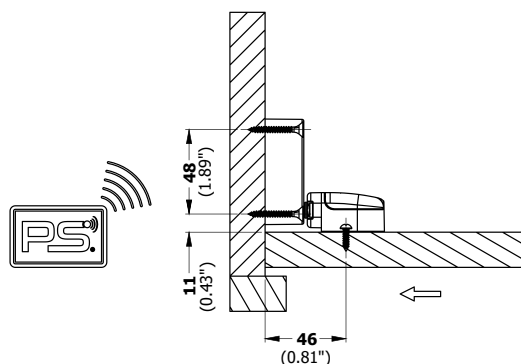
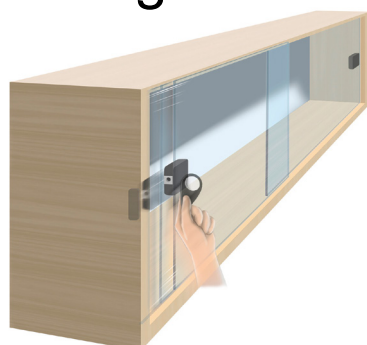



The SOLO furniture lock is used on doors, drawers and sliding doors and fastened to the respective door or panel on the inside. It is not visible from the outside. The SOLO lock is then operated with key cards, key rings, Bluetooth App or mobile phones.

The RFID reading range and battery life depends on the technology used and the quality of the key units or battery used.

SOLO 125 kHz

- Access control for up to 49 RFID keys
- EM4102 / EM4200 RFID technology
- Software: BOLT - does not lock automatically, but with the card
- Software: GYM - free choice of lockers
- Software: ALARM - an alarm appears if the door is not closed

ARTICLE №	FEATURE	TECHNOLOGY
SOLO	With trap function, locks automatically after three seconds	125 kHz
SOLO 125 +	For applications with ALARM or GYM	125 kHz

Accessories for SOLO 125 kHz









					
Latch 74 page 37	Latch 75 page 37	Battery CR 123A page 38	Programming card page 39	Key card page 39	Key fob page 39
					
Key sticker page 40	External antenna page 40	External power supply page 41	Glass mounting kit page 38	Metal mounting kit page 38	Powerbank page 40

SOLO13 (13,56MHz)

- Access control for up to 49 RFID keys
- Mifare ISO 14443A RFID Technology
- Software: BOLT - does not lock automatically, but with the card
- Software: GYM - free choice of lockers for gyms
- Software: ALARM - an alarm appears if the door is not closed

ACTICLE №	FEATURE	TECHNOLOGY
SOLO 13	With trap function, locks automatically after three seconds	13,56 MHz
SOLO 13 +	For applications with ALARM or GYM	13,56 MHz
SOLO 13 EXT	With trap function and external antenna	13,56 MHz
SOLO 13 EXT+	For applications with ALARM or GYM	13,56 MHz

Accessories for SOLO13

					
Latch74 page 37	Latch 75 page 38	Battery CR 123A page 38	Programming card page 39	Key card page 39	Key fob page 39
					
Glass mounting kit page 38	Metal mounting kit page 38	Powerbank page 40			

SOLO BT

- Bluetooth Technology enables this lock to be also used with metal cabinets
- Controllable with the "PSLocks" app or with your own app

ACTICLE №	FEATURE	TECHNOLOGY
SOLO BT+	Controllable with an APP	Bluetooth

Accessories for SOLO BT

				
Latch74 page 37	Latch 75 page 37	Battery CR 123A page 38	Glass mounting kit page 38	Powerbank page 40

SOLO SECONDARY LOCK

The SOLO SECONDARY LOCK is plugged directly into the back of the SOLO 125, SOLO 13 or SOLO BT and opens at the same time. The cable length is 1,5 m in standard and can also be changed on request. Alternatively, the SOLO SECONDARY LOCK can also be controlled by other microprocessors.

For the 1,5 m cable the following occupancy applies:

- White – control line, LOW = open, HIGH = close
- Black center: Plus 3V
- Black outside: Minus GND

ACTICLE №	FEATURE	TECHNOLOGY
SOLO SECONDARY SET	Lock including 1,5 m cable and spacer plate	SECONDARY

Accessories for SOLO SECONDARY LOCK



Connection cable

page 41



Latch 75

page 37



Spacer plate

page 41

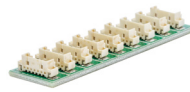

Extension board

page 42

SOLO 3V / 12V DC

SOLO 3V

The SOLO 3V is operated with a voltage of 2-3V DC and has a cable length of 1,5 m. A switch or a relay is used.

Connection:

- Blue – GND / Minus
- Brown – open
- Black – close

SOLO 12V

The SOLO 12V is operated with a voltage of 8-16V DC and has a cable length of 1,5 m. A switch or a relay is used.

Connection:

- Blue – GND / Minus
- Brown – open
- Black – close

ACTICLE №	FEATURE	TECHNOLOGY
SOLO 3V	Lock with 1,5 m cable	3V DC
SOLO 12V	Lock with 1,5 m cable	12V DC
SOLO 12V+	Lock with 1,5 m cable and "door closed" switch	12V DC

Accessories for SOLO 3V /12V DC



Latch 74

page 37



Latch 75

page 37

TEN

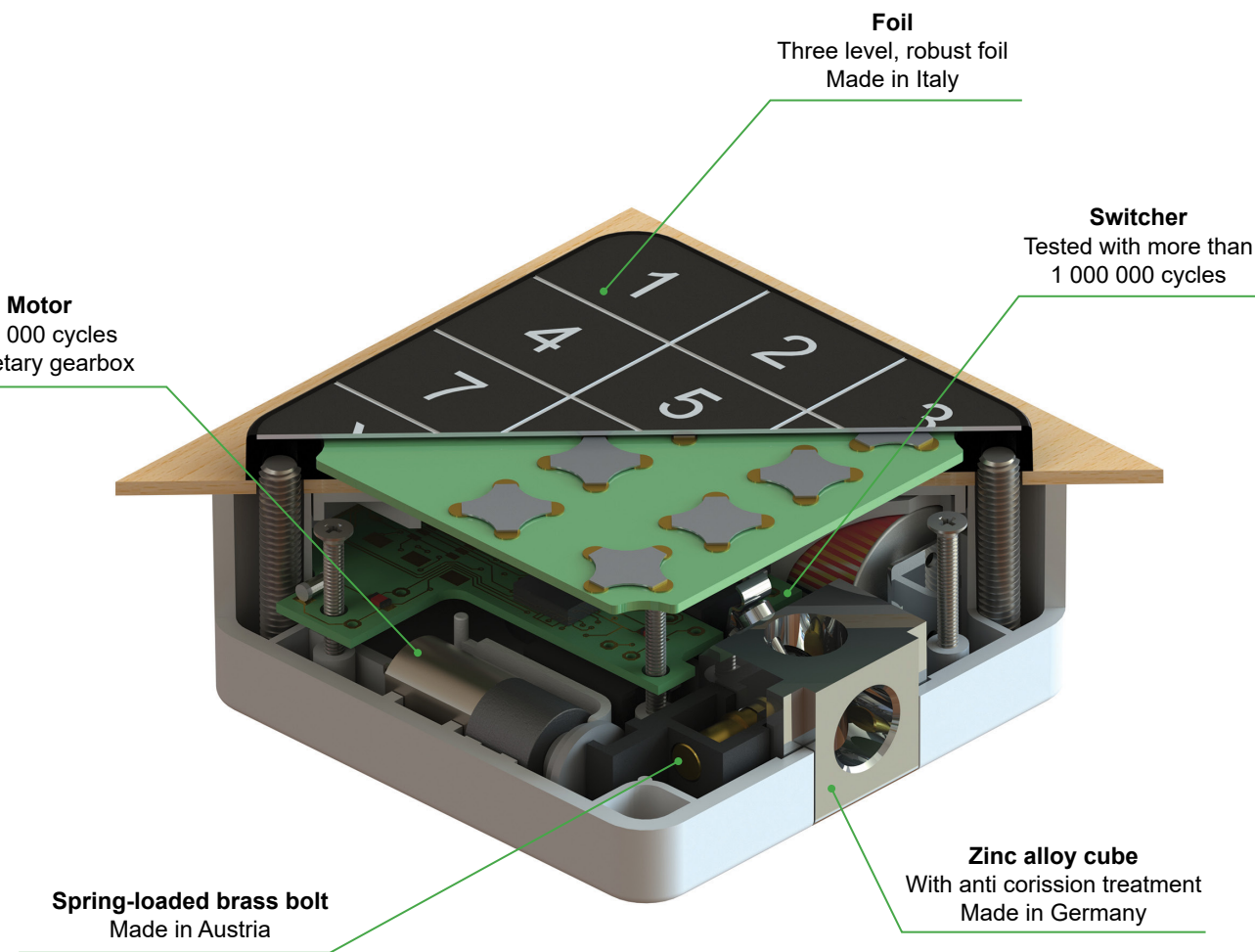

Doors



Drawers



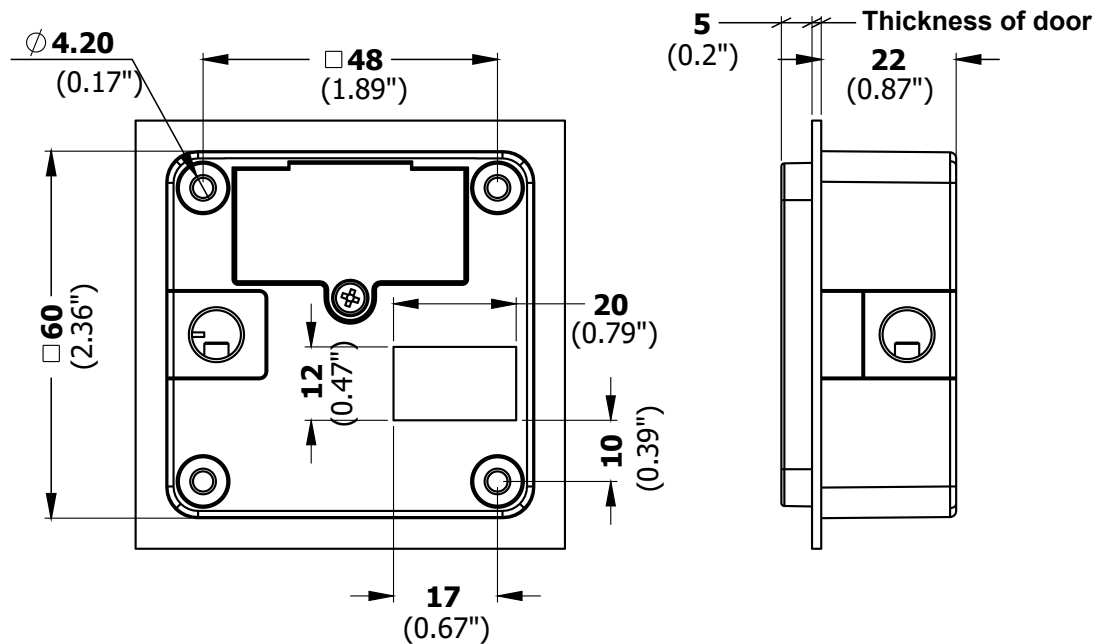

The TEN combination lock enables the locking of furniture by a combination of numbers.

The keypad is attached to the outside of the door and bolted to the lock on the inside. The 7 cm cable connects the two components through a pre-drilled hole in the door.

Delivery:

- Lock with keypad
- Locking part LATCH74
- Screws for a 16/19 mm front
- Battery

On request, screws can also be supplied for varying frontal thicknesses.

About Us

SOLO

TEN

TWO

PLUR

QUAD

MINI

FLIN

PAD II

BEETLE

Accessories

Programming

TEN PUBLIC

- Individual 4-digit code for public institutions
- Free locker choice
- Open with previously used code which is subsequently deleted
- Opened at rest
- Simple emergency opening with master code

ACTICLE №	FEATURE	KEYBOARD COLOR
TEN PUBLIC 74BS	For public areas with free choice of cabinets	Black
TEN PUBLIC 74BW	For public areas with free choice of cabinets	White

TEN PRIVATE

- 4-digit code for private use or workplace
- Closed at rest
- When entering the code, the lock unlocks for 3 seconds
- Simple emergency opening with master code (orders from 01/2023)

ACTICLE №	FEATURE	KEYBOARD COLOR
TEN PRIVATE 74BS	For private use with fixed code	Black
TEN PRIVATE 74BW	For private use with fixed code	White

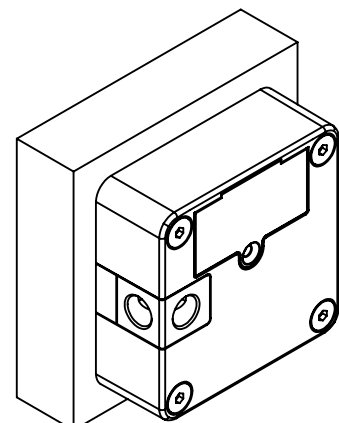
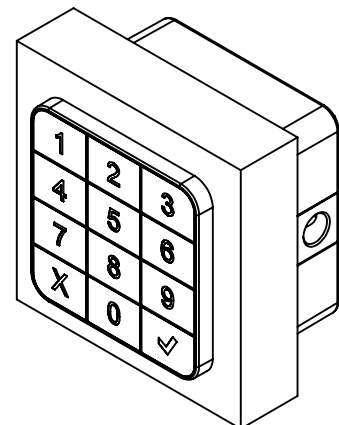
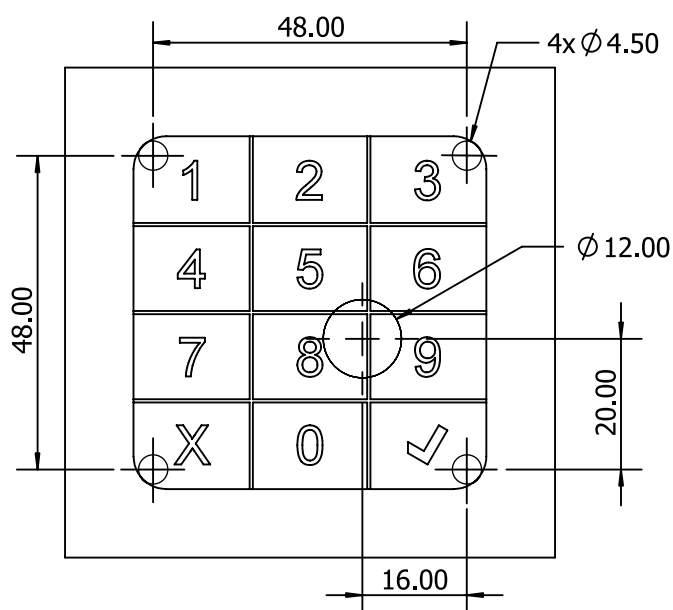

TWO

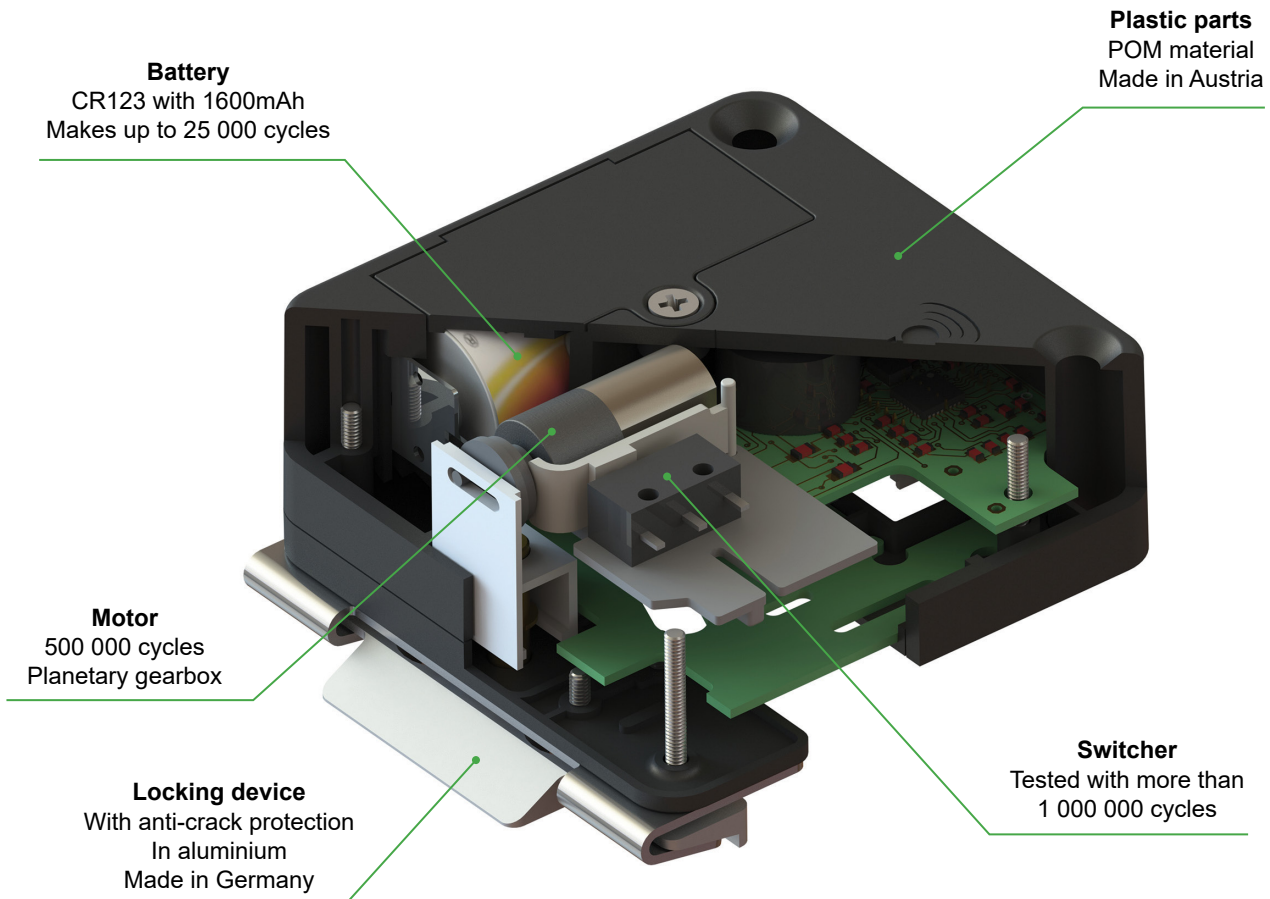

Wooden Slidingdoors



Glass Slidingdoors



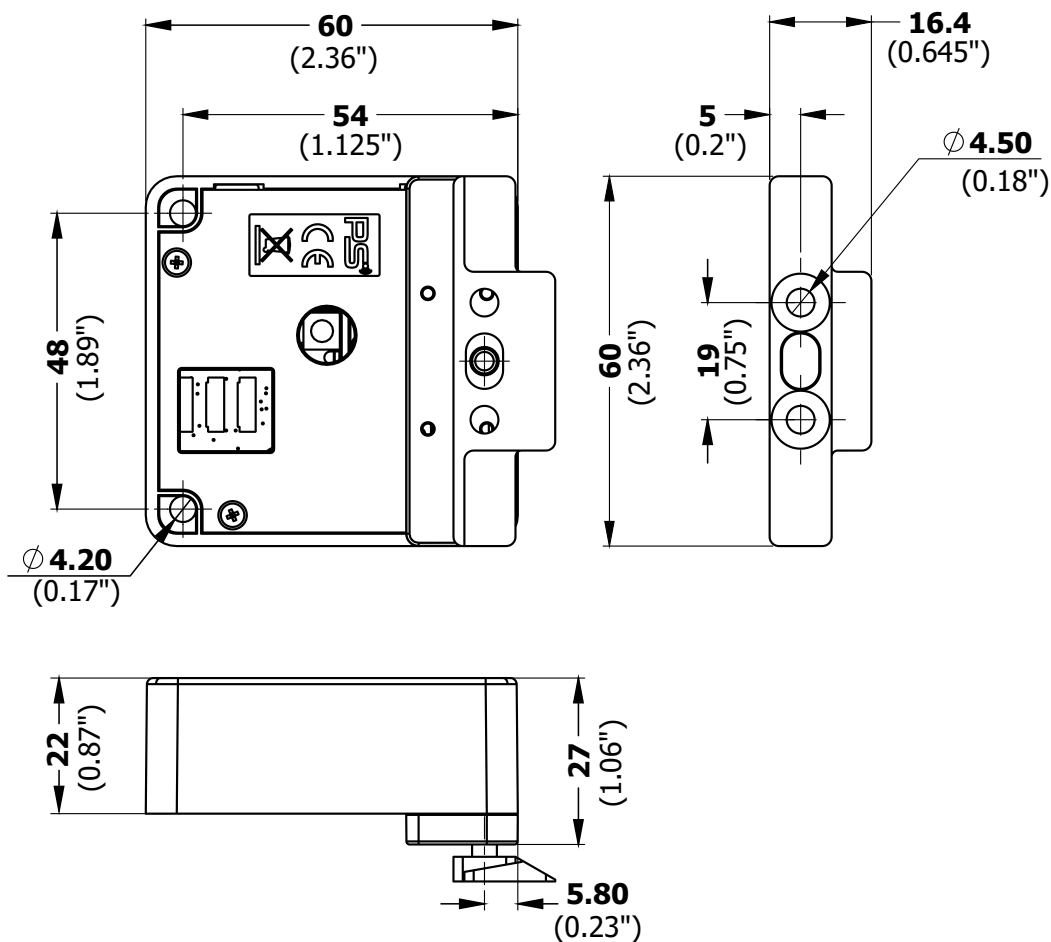

The TWO is an electronic furniture lock which is installed in between two sliding doors. For wooden doors it is bolted and is not visible from the outside. For glass doors, the lock is glued with the 3M adhesive film and the closing part with UV adhesive.

Due to the crack protection in the closing part, the lock cannot be opened by pulling on the door.

There are two standard versions:

The TWO 10 (5 mm glass door thickness + 5 mm space between the doors) and the TWO 16 (12 mm wood door thickness + 4 mm space between the doors).

The RFID reading range and battery life depends on the technology used and the quality of the key units or battery used.

TWO 125

- Access control for up to 49 RFID keys
- EM4102 / EM4200 RFID technology

ACTICLE №	FEATURE	TECHNOLOGY
TWO 125 10	Suitable for glass doors 5 mm + 5 mm distance	125 kHz
TWO 125 16	Suitable for wooden doors 12 mm + 4 mm distance	125 kHz

Accessories for TWO 125





				
Battery CR 123A	Programming card	Key card	Key fob	Key sticker
page 38	page 39	page 39	page 39	page 40

TWO 13

- Access control for up to 49 RFID keys
- Mifare ISO 14443A RFID technology

ACTICLE №	FEATURE	TECHNOLOGY
TWO 13 10	Suitable for glass doors 5 mm + 5 mm distance	13,56 MHz
TWO 13 16	Suitable for wooden doors 12 mm + 4 mm distance	13,56 MHz

Accessories for TWO 13

			
Battery CR 123A	Programming card	Key card	Key fob
page 38	page 39	page 39	page 39

TWO BT

- Bluetooth Technology enables this lock to be also used with metal cabinets
- Controllable with the "PSLocks" app or with your own app

ACTICLE №	FEATURE	TECHNOLOGY
TWO BT 10	Suitable for glass doors 5 mm + 5 mm distance	Bluetooth
TWO BT 16	Suitable for wooden doors 12 mm + 4 mm distance	Bluetooth

Accessories for TWO BT

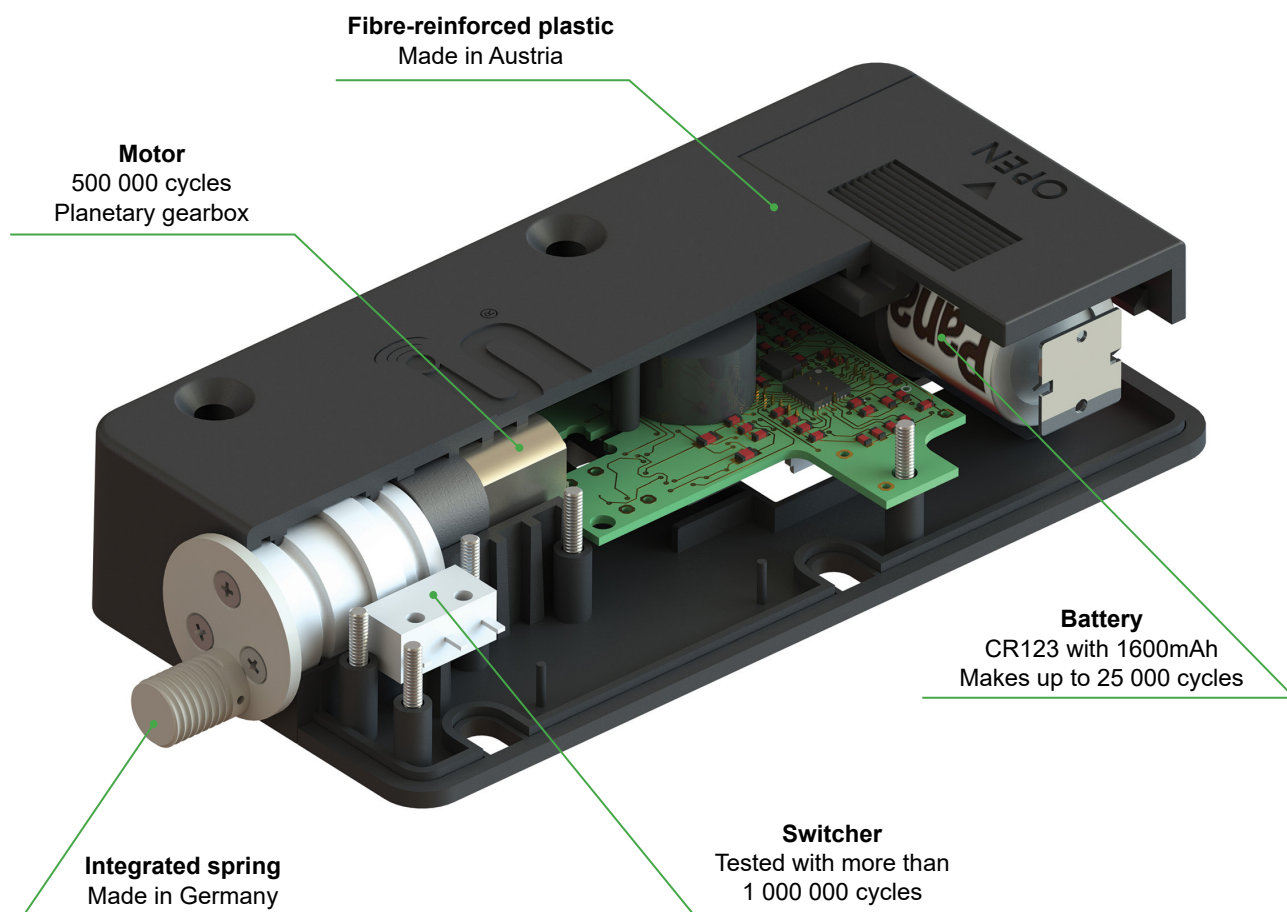

Battery CR 123A
page 38

PLUR



Drawers

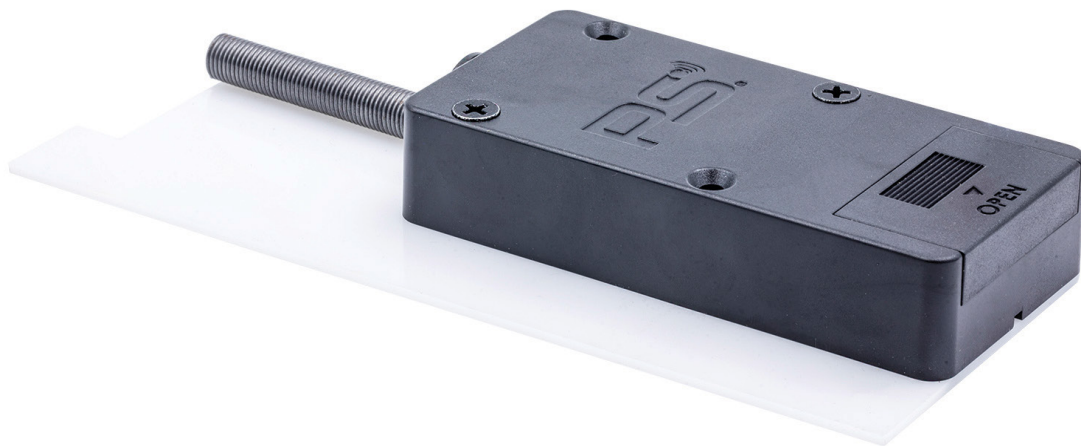
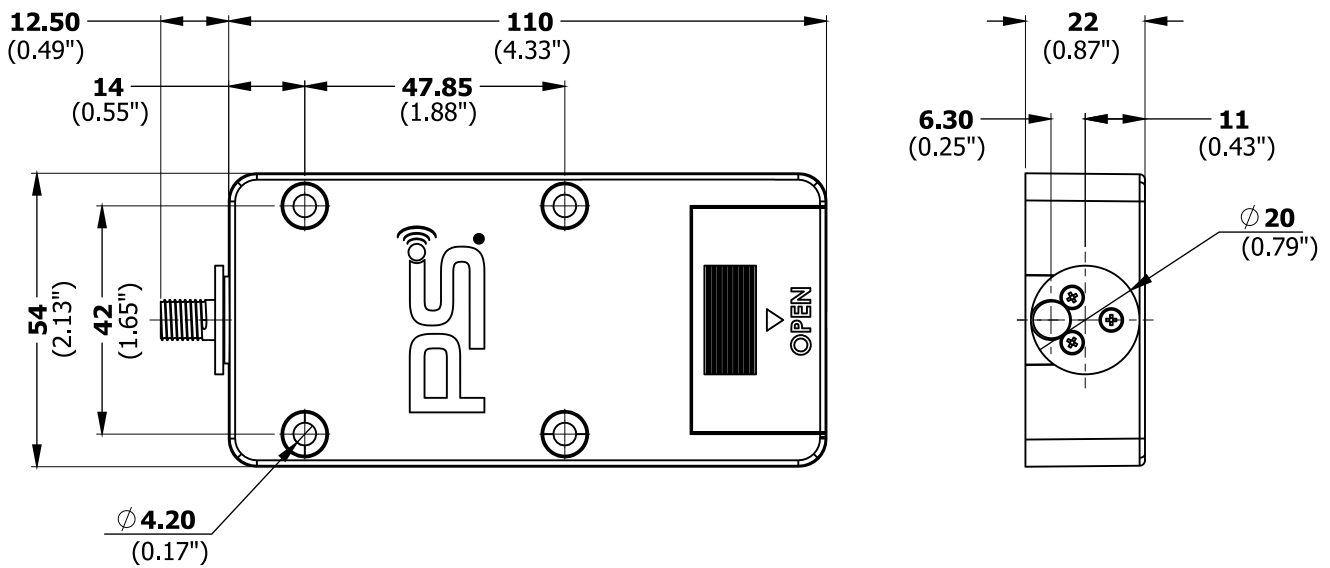



The PLUR BLUM lock enables the locking of several superimposed drawers via a central locking bar.

The assemblage is located at the top of the lid of the furniture on the inside. With wide drawers, a PLUR SECONDARY BLUM LOCK can be connected with a cable, which then opens at the same time.

Due to the integrated spring, the drawer does not necessarily have to be closed to lock the lock.

The RFID reading range and battery life depends on the technology used and the quality of the key units or battery used.

PLUR BT BLUM

- Bluetooth Technology enables this lock to be also used with metal cabinets
- Controllable with the "PSLocks" app or with your own app.

ACTICLE №	FEATURE	TECHNOLOGY
PLUR BT BLUM	Electronic locking system for a multi-drawer assembly	Bluetooth

Accessories for PLUR BT BLUM



Battery CR 123A

page 38



Powerbank

page 40

PLUR SECONDARY BLUM LOCK

The PLUR SECONDARY BLUM LOCK is a central locking lock which can be connected directly to the back of the PLUR 125 Blum, PLUR 13 Blum or PLUR BT , thus allowing simultaneous opening of very wide drawers. The cable length is 1,5 m. Any other microprocessor may be used for control.

For the supplied 1,5 m cable, the following applies:

- White – control line, LOW = open, HIGH = close
- Black center: Plus 3V
- Black outside: Minus GND

ACTICLE №	FEATURE	TECHNOLOGY
PLUR SECONDARY BLUM	Electronic locking system for a multi-drawer assembly	HIGH/LOW

PLUR BLUM

With the PLUR blum adapter plate PLUR Blum locks can be connected directly to the blum Cabloxx system. The adapter plate is designed so that it is placed flush with the front and sides and screwed together with the lock.

The products are identical apart from the pre-attached adapter plate.

ACTICLE №	FEATURE	TECHNOLOGY
PLUR 125 blum	Electronic locking system for a multi-drawer assembly	125 kHz
PLUR 13 blum	Electronic locking system for a multi-drawer assembly	13,56 MHz
PLUR BT blum	Electronic locking system for a multi-drawer assembly	Bluetooth
PLUR SECONDARY blum	Electronic locking system for a multi-drawer assembly	HIGH/LOW
PLUR 3V blum	Electronic locking system for a multi-drawer assembly	3V DC
PLUR 12V blum	Electronic locking system for a multi-drawer assembly	12V DC

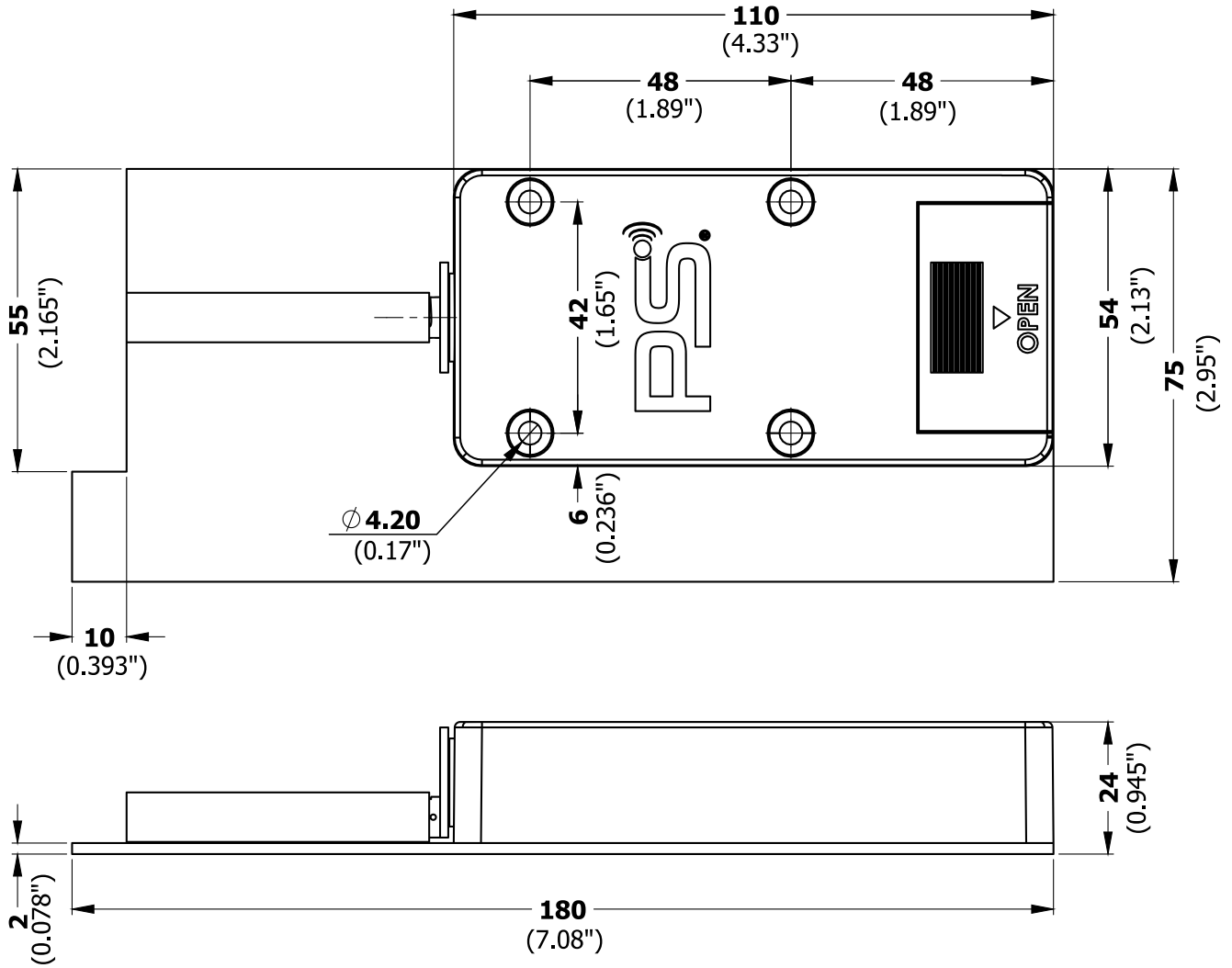

QUAD

Gearbox
Fibre-reinforced plastic
For a robust gearbox
Made in Austria

Robust metal casing
Made in Germany

Fibre-reinforced plastic
Made in Austria

Switcher
Tested with more than
1 000 000 cycles

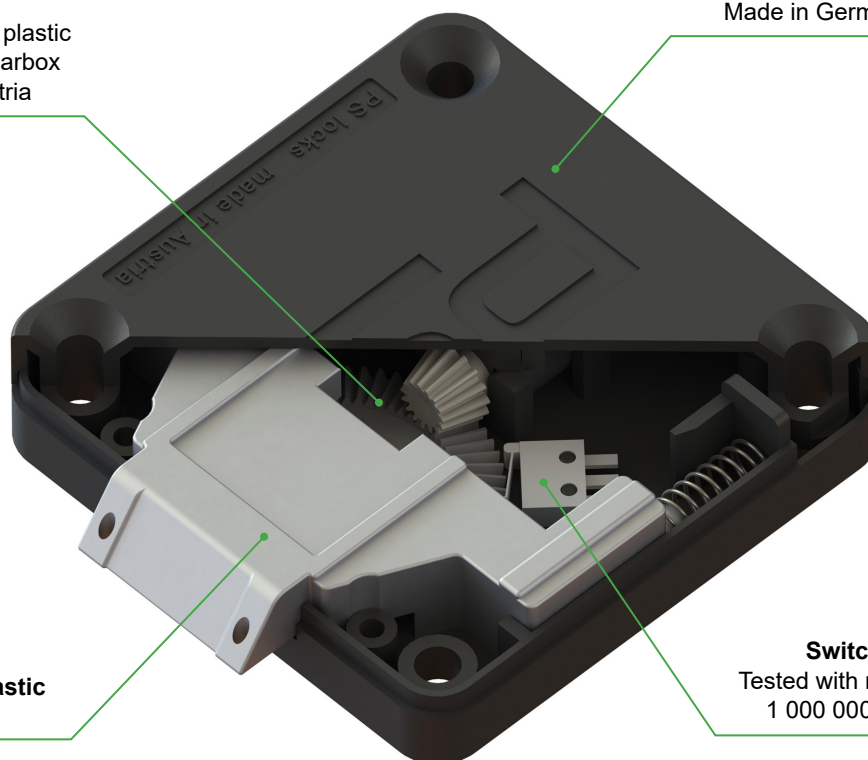

Doors



Drawers



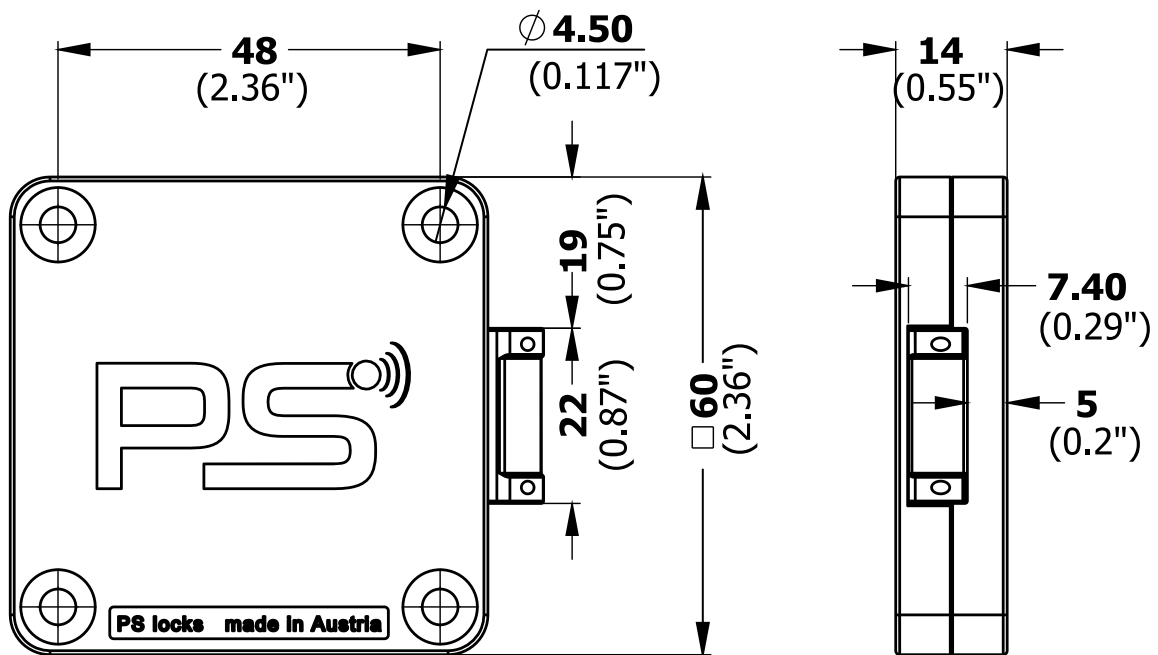

Due to the low height and the internal gear, the QUAD furniture lock is very sturdy and can be used in many ways. The electronics are in a separate housing which can be attached to the top, side or front of the furniture. The electronics are connected by a cable and powered by 2 AAA batteries.

The lock itself has a zinc die-cast housing and is also available without electronics as 3V / 12V or SECONDARY LOCK.

The QUAD lock is used on post boxes, furniture and glass doors.

The RFID reading range and battery power depends on the technology used and the quality of the RFID key units or battery used.

About Us

SOLO

TEN

TWO

PLUR

QUAD

MINI

FLIN

PAD II

BEETLE

Accessories

Programming

QUAD 125

- Access control for up to 49 RFID keys
- EM4102 / EM4200 RFID technology

ACTICLE №	FEATURE	TECHNOLOGY
QUAD 125	Set with lock and electronics	125 kHz

Accessories for QUAD 125







				
Quad locking part for doors and drawers	Battery CR 123A	Programming card	Key card	Key fob
page 43	page 38	page 39	page 39	page 39
				
Key sticker	Glass mounting set	Powerbank		
page 40	page 38	page 40		

QUAD 13

- Access control for up to 49 RFID keys
- Mifare ISO 14443A RFID technology

ACTICLE №	FEATURE	TECHNOLOGY
QUAD 13	Set with lock and electronics	13,56 MHz

Accessories for QUAD 13

					
Quad locking part for doors and drawers	Battery CR 123A	Programming card	Key card	Glass mounting set	Powerbank
page 43	page 38	page 39	page 39	page 38	page 40

QUAD BT

- Bluetooth Technology enables this lock to be also used with metal cabinets
- Controllable with the “PSLocks” app or with your own app

ACTICLE №	FEATURE	TECHNOLOGY
QUAD BT	Set with lock and electronics	Bluetooth

Accessories for QUAD 125

			
Quad locking part for doors and drawers	Battery CR 123A	Glass mounting set	Powerbank
page 43	page 38	page 38	page 40

QUAD SECONDARY LOCK

The QUAD SECONDARY LOCK allows control over other microprocessors. The cable length is 1,5 m in standard and can also be changed on request.

For the 1,5 m cable the following occupancy applies:

- White – control line, LOW = open, HIGH = close
- Black center: Plus 3V
- Black outside: Minus GND

ACTICLE №	FEATURE	TECHNOLOGY
QUAD SECONDARY	Lock with 1,5 m cable	SECONDARY

QUAD 3V / 12V DC

QUAD 3V

The QUAD 3V is operated with a voltage of 2-3V DC and has a cable length of 1,5 m. A switch or a relay is used.

Connection:

- Blue – GND / Minus
- Brown – open
- Black – close

ACTICLE №	FEATURE	TECHNOLOGY
QUAD 3V	Lock with 1,5 m cable	3V DC
QUAD 12V	Lock with 1,5 m cable	12V DC

QUAD 12V

The QUAD 12V is operated with a voltage of 8-16V DC and has a cable length of 1,5 m. A switch or a relay is used.

Connection:

- Blue – GND / Minus
- Brown – open
- Black – close

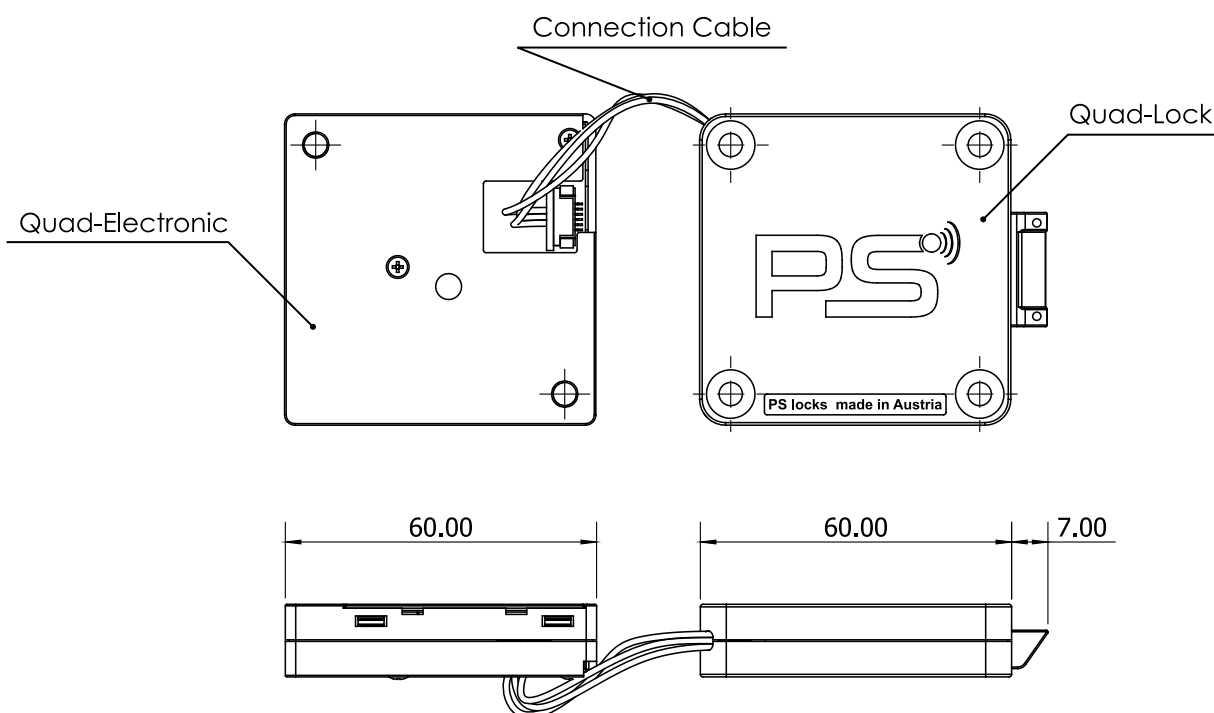

MINI

Robust metal casing
Out of zinc-die cast
Made in Germany

Switcher
tested with more than
1 000 000 cycles

Motor
500 000 cycles
Planetary gearbox

Pusher
for the door open contact

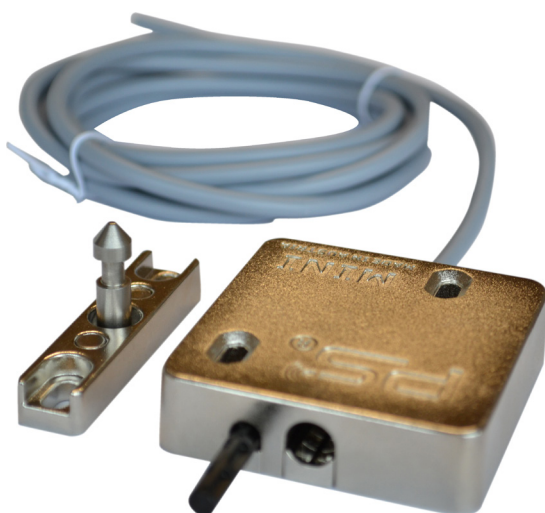

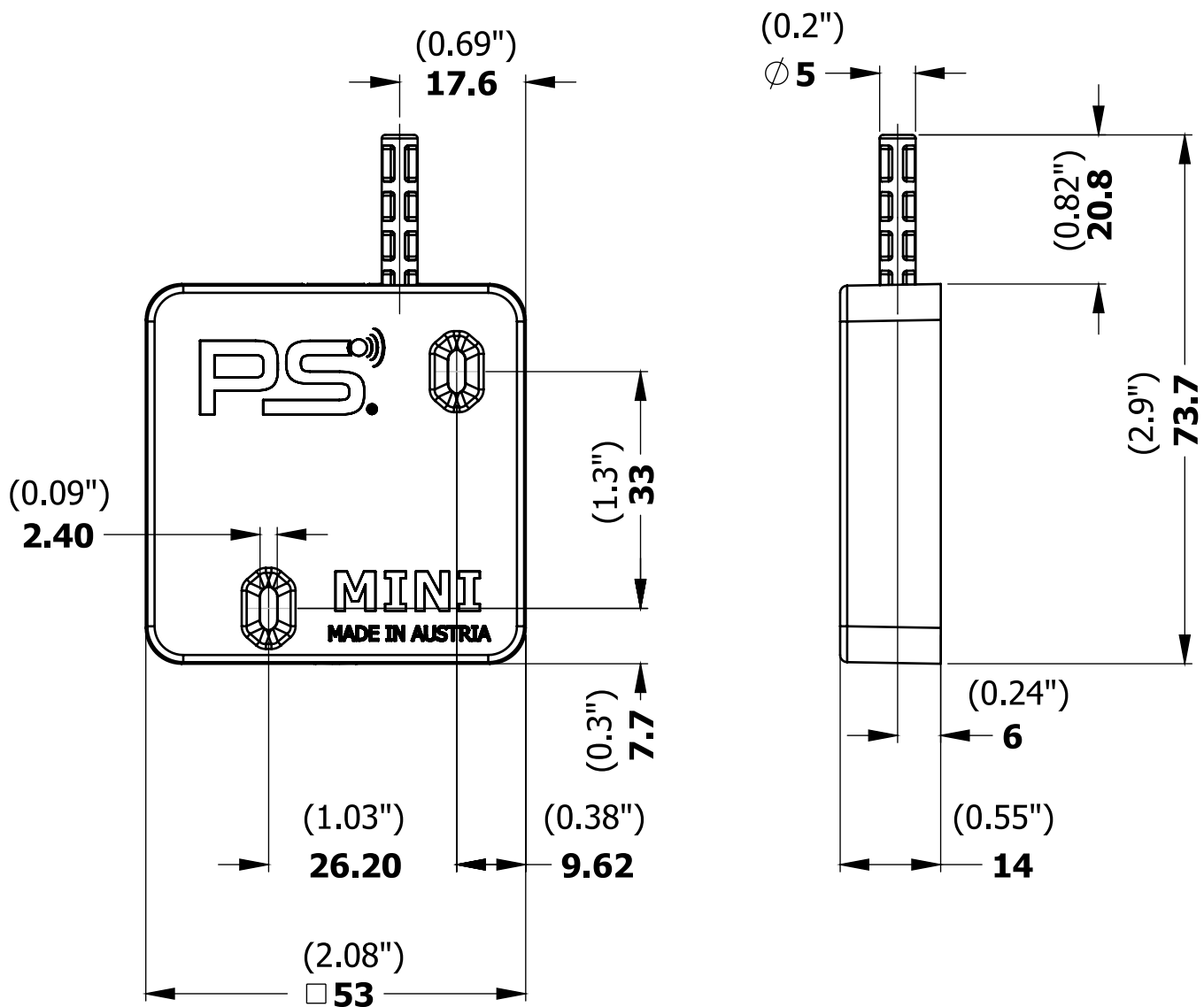

With dimensions of 53x53x14 mm, the MINI furniture lock offers a wide range of applications such as doors, drawers or sliding doors.

VOLTAGES:

The MINI Lock is controlled with 2 or 12V DC, depending on the version.

POWER CONSUMPTION:

When the lock has reached the open/closed position, the current consumption is interrupted. During open/close, only a current of 300mA is required for 0.3 seconds.

SPRING MECHANISM:

With 25NM, the MINI lock in the version has the spring bolt (pusher) enough force to make a revolving door spring open as soon as the lock has opened.

DOOR CLOSED CONTACT:

Optionally, the MINI lock can be equipped with a potential-free switch, which is closed as soon as the door is closed. This switch also opens reliably if the door is opened by force. This can only be used in combination with the spring mechanism.

TOLERANCES:

The slotted holes allow the lock to be adjusted to the depth of the furniture. The locking part can be adjusted laterally and the middle pin has a general tolerance of 1.5mm.

Voltages: 2V, 12V

Cable lengths: 2 m / According to customer's requirements

Selection: with/without door contact and pusher

ACTICLE №	FEATURE	TECHNOLOGY
MINI 2V	Set with lock and electronics	2V
MINI 12V	Set with lock and electronics	12V

Accessories for MINI 2V/ 12 V



Latch MINI

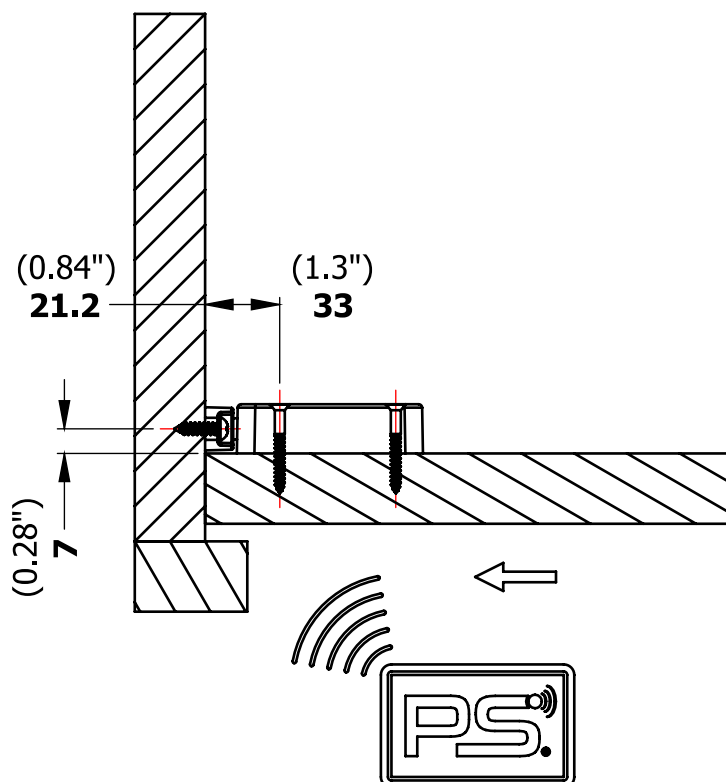

FLIN

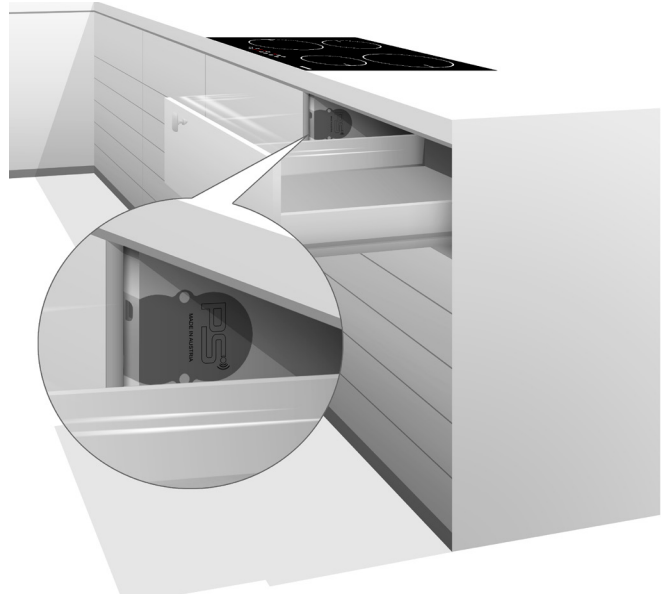
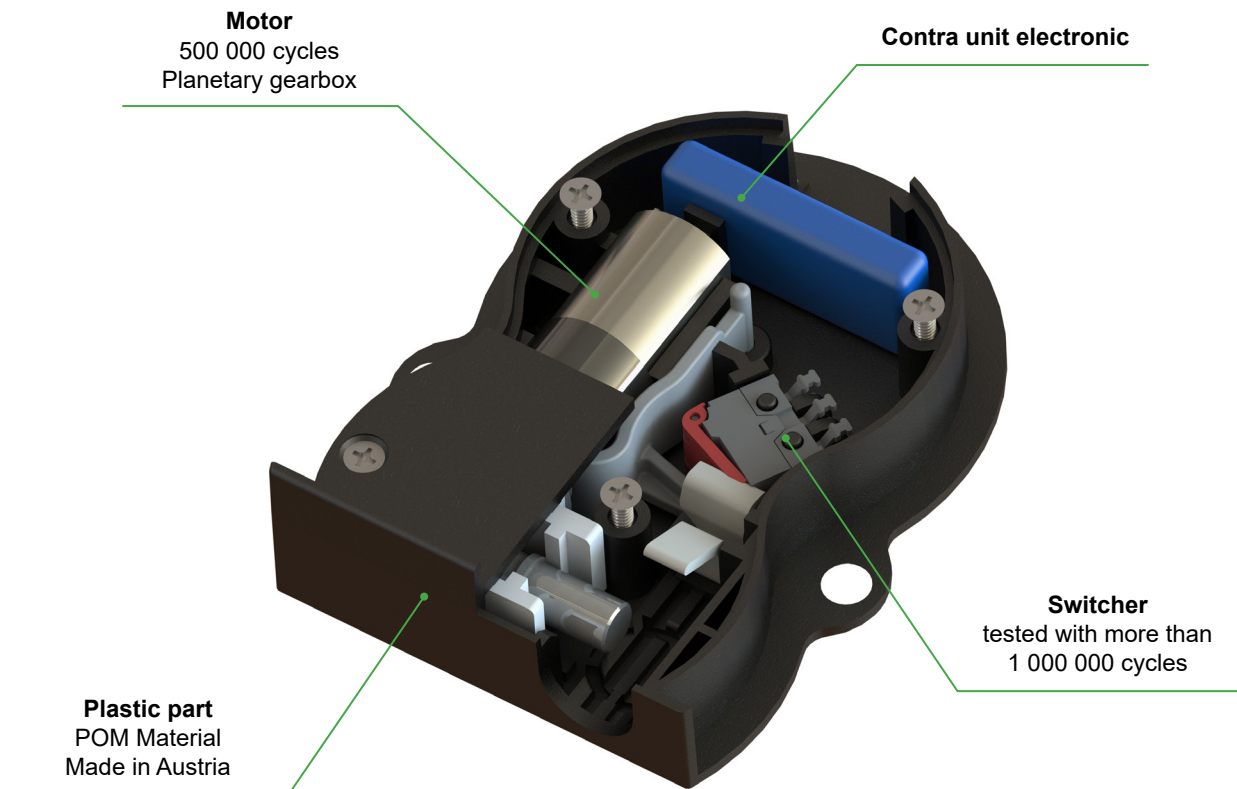

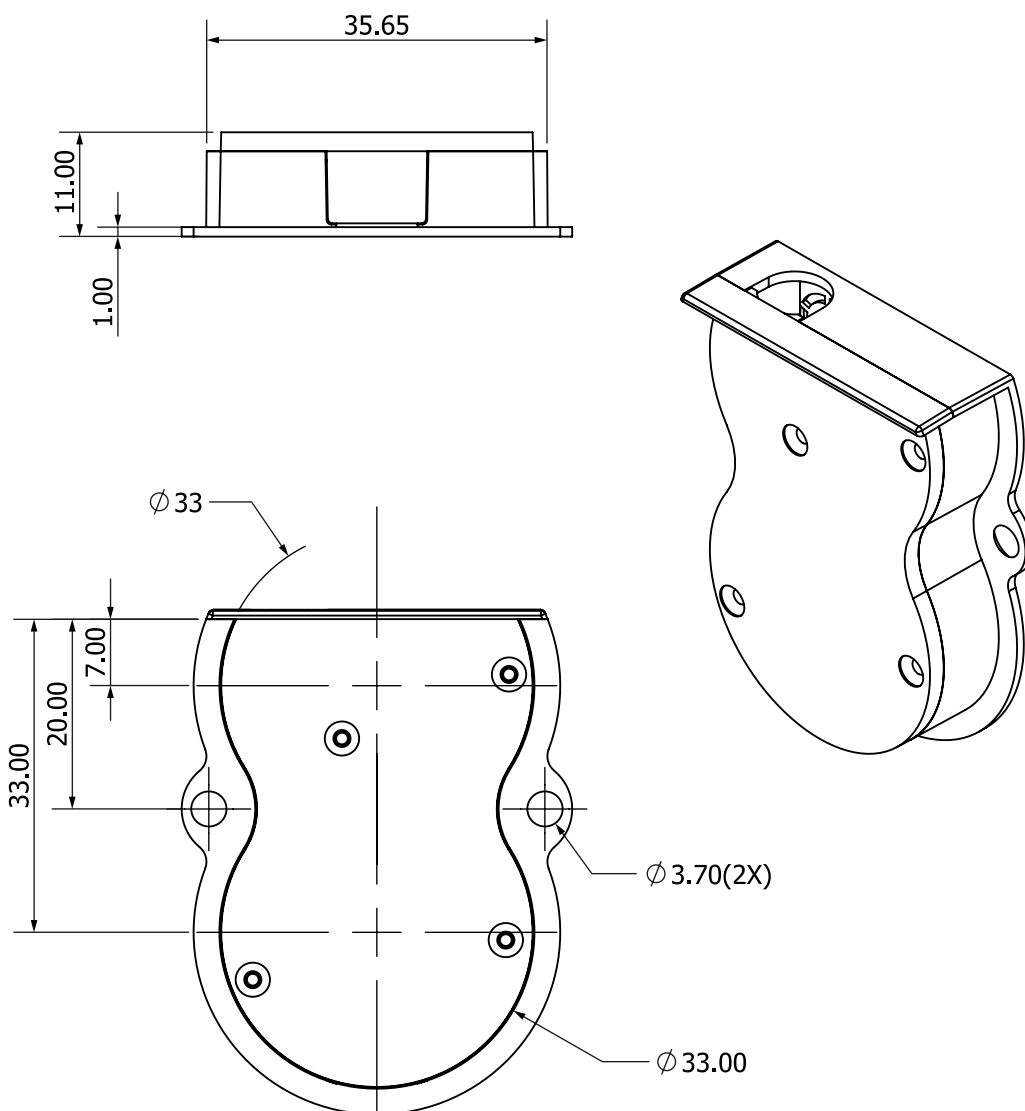

The FLIN lock is milled into the side walls and connected to a SOLO or directly to external voltage with cable.

It can be used on swing doors and for drawers a side clearance of 1,5 mm is sufficient.

FEATURES:

- adjustable locking device
- small, robust motor
- milled into side wall
- slim enough for 16mm side walls

FLIN 2,5V/ 12 V

The FLIN lock is operated with a voltage of 2-2,5V or 8-16V DC. A switch or a relay is used to control it.

FLIN 2,5V

- Black – GND / Minus
- Green – open
- Yellow – close
- 1.5 m cable

FLIN 12 V

- Black – GND / Minus
- Red – open
- Green – close
- 1.5 m cable

Current consumption at maximum load: 500 mA

Current consumption in normal condition: 100 mA

ACTICLE №	FEATURE	TECHNOLOGY
FLIN 2,5V	Lock with 1,5m cable	2,5V
FLIN 12V	Lock with 1,5m cable	12V

Accessories for FLIN 2,5V/ 12 V



FLIN Latch

page 37

FLIN SECONDARY

The FLIN SECONDARY lock is usually used in combination with a SOLO Bluetooth or SOLO125 with external Antenna and can be connected to the back of the SOLO.

Alternatively, any other microprocessor may be used for control.

Attention: If you use the FLIN SECONDARY in combination with a battery driven SOLO lock, it will stay open in case of a battery-low alarm.

ACTICLE №	FEATURE	TECHNOLOGY
FLINSECONDARY	lock with 1,5 m cable with direct plug	SECONDARY

Accessories for FLIN SECONDARY



FLIN Latch

page 37

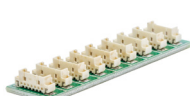

Extension board

page 42

SECTION A-A
SCALE 3 : 1

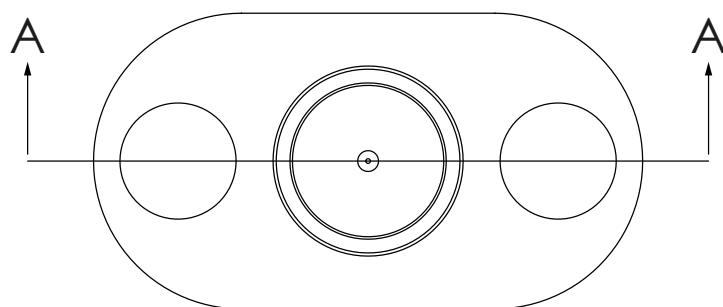
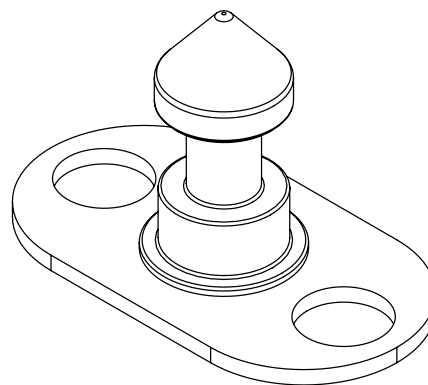
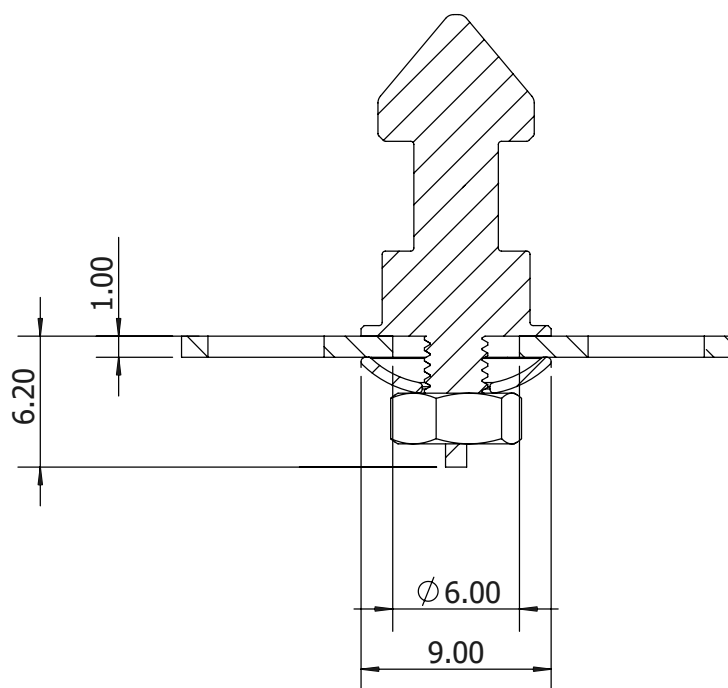

PAD II

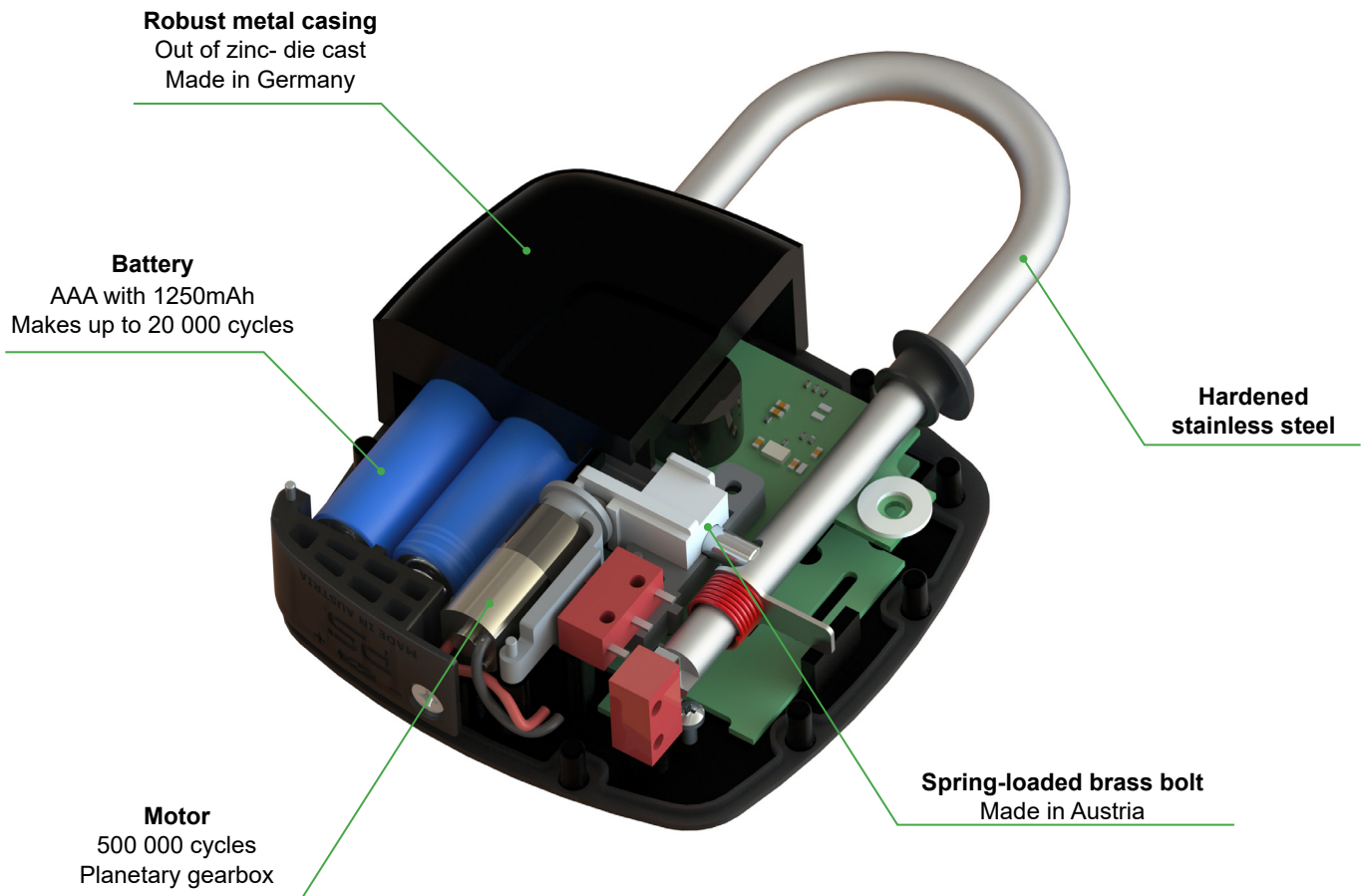

Doors

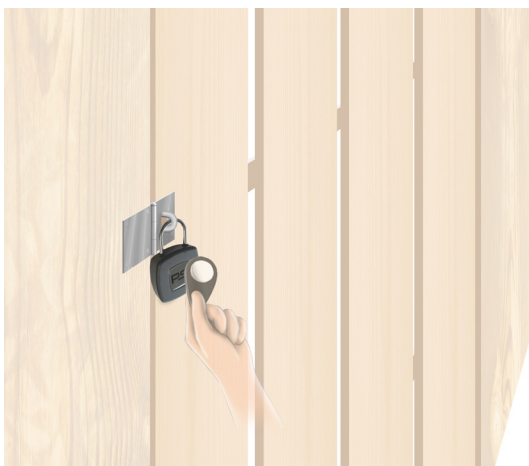

Surprise your loved ones, your friends or your employees with a innovative padlock.

The two pieces of AAA batteries are located behind the unscrewed cover. The battery lifetime is approx. 2 years or 20.000 opening. That depends on the quality of the used battery.

Temperature range: 5-35°C (New model with -20° - 40°C in development).

TECHNOLOGY

The lock can be controlled via Bluetooth. The "PSLocks" - App, which is provided free of charge, offers a user-friendly application for controlling the lock.

OPEN SOURCE

Thanks to an open API interface, the lock is also ideally suited for controlling your own existing solutions. The API can be easily downloaded online.

Surface:

- Zinc die-cast housing
- Hardened steel bracket

Basic parameter:

- Height: 7,5 cm
- Depth: 7,45 cm
- Thickness: 2,45 cm

PAD II BT

- Controllable with the "PSLocks" app or with your own app

ACTICLE №	FEATURE	TECHNOLOGY
PAD II BT	Electronic padlock	Bluetooth

Accessories for PAD II BT



Battery AAA

page 42

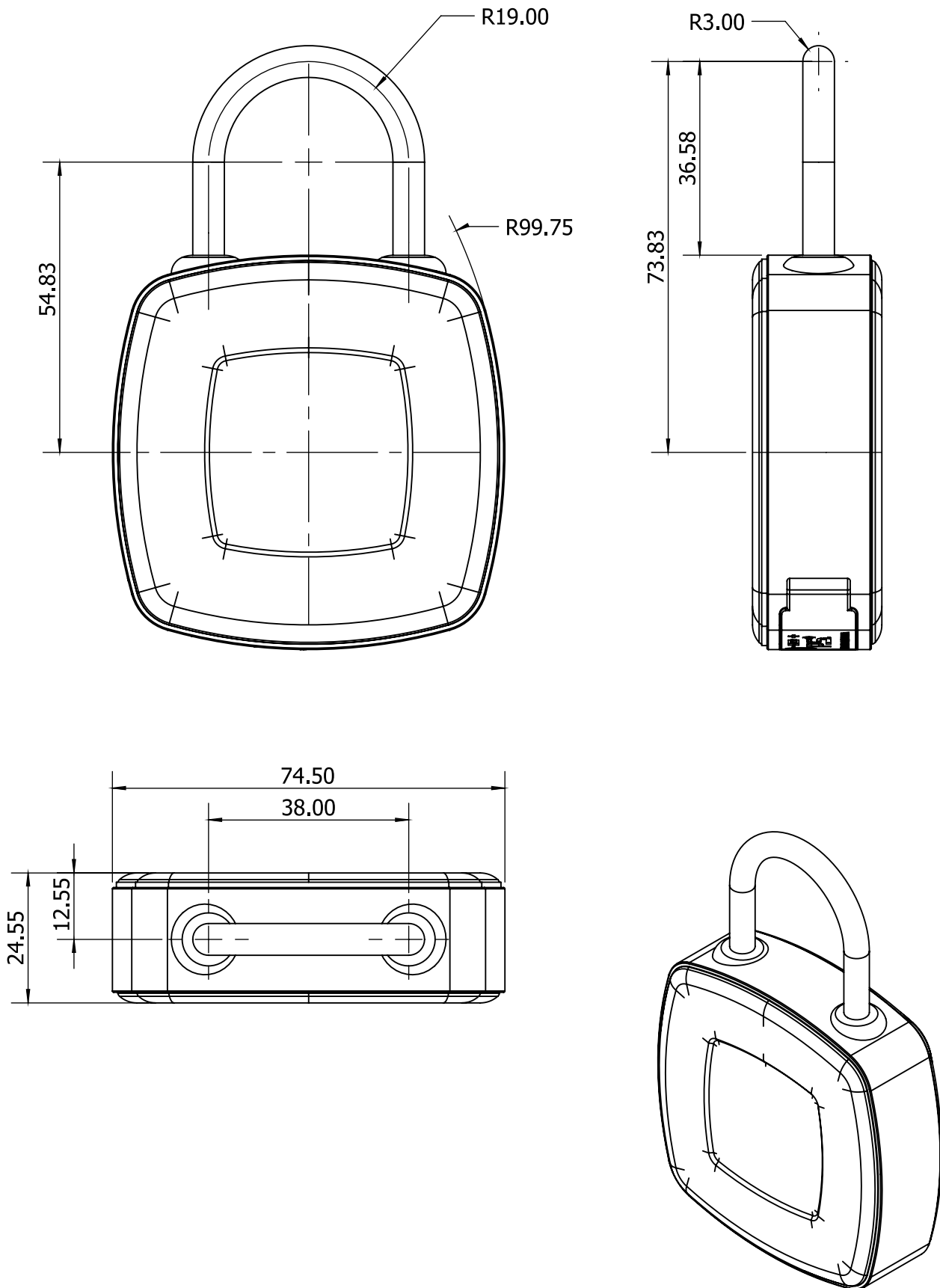

BEEBLE

Motor
500 000 cycles
Planetary gearbox

Robust metal casing
Powder coloured
Made in Germany

Switcher
Tested with more than
1 000 000 cycles

Spring-loaded brass bolt
Made in Austria

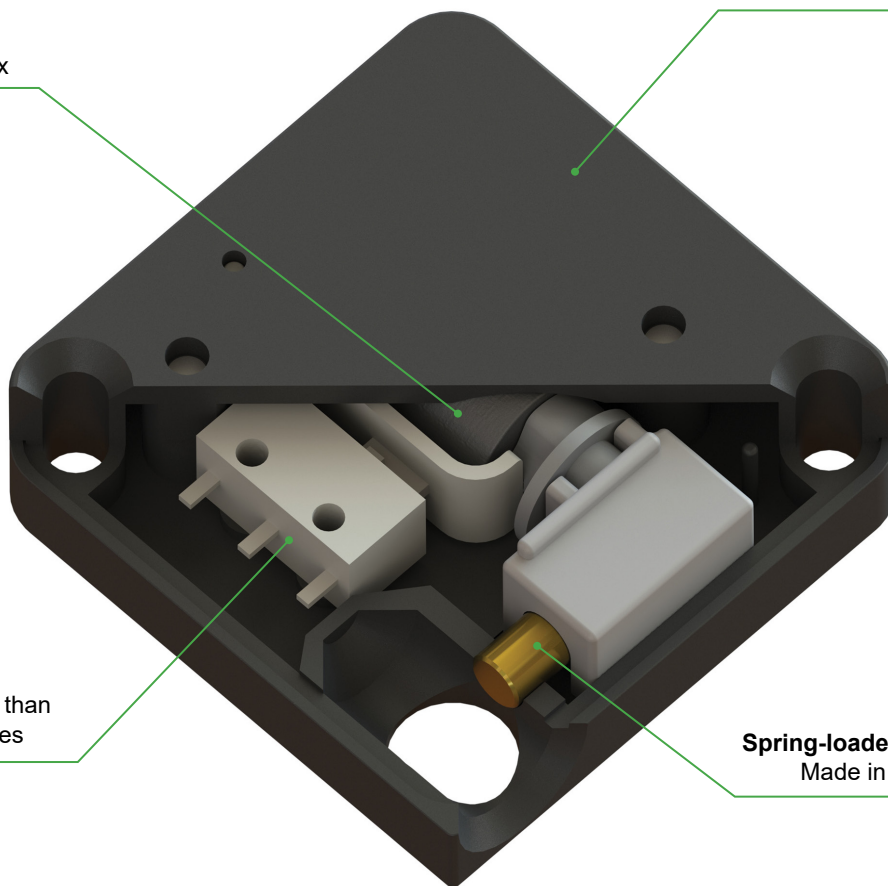

Doors



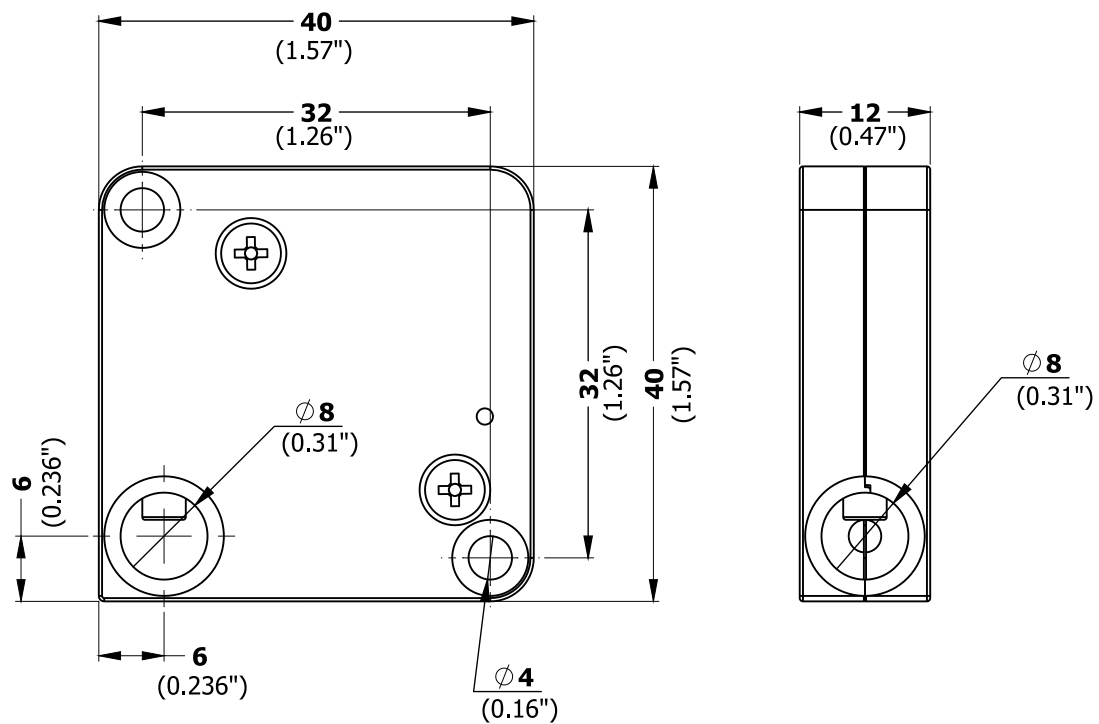

The BEETLE is an electromechanical furniture lock, which is connected either to a SOLO lock or directly to external voltage.

The small, robust design is suitable for a range of applications from showcases through drawers to caravans or boats.

All versions are equipped with a 1,5 m cable. The length and possible plugs can be adjusted on request.

The housing is made of stable die-cast zinc and the power consumption is 100 to a maximum of 500 mA for 0,3 seconds. If the lock has reached an end position, no electricity flows. If there is a loss of power, the lock remains in the last position.

About Us

SOLO

TEN

TWO

PLUR

QUAD

MINI

FLIN

PAD II

BEETLE

Accessories

Programming

BEETLE SECONDARY LOCK

The BEETLE SECONDARY LOCK is usually used in combination with a SOLO lock and can be connected to the back of the SOLO. Alternatively, any other microprocessor may be used for control.

For the 1,5 m cable the following occupancy applies:

- White – control line, LOW = open, HIGH = close
- Black center: Plus 3V
- Black outside: Minus GND

ACTICLE №	FEATURE	MATERIAL
BEETLE SECONDARY	Lock for combination with a SOLO as a group	Die-cast zinc

Accessories for BEETLE SECONDARY LOCK



Mini locking device

page 42

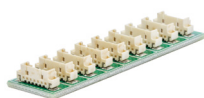

Extension board

page 42

BEETLE 3V / 12V DC

BEETLE 3V

The BEETLE 3V is operated with a voltage of 2-3V DC. A switch or a relay is used.

Connection:

- Blue – GND / Minus
- Brown – open
- Black – close

BEETLE 12V

The BEETLE 12V is operated with a voltage of 8-16V DC. A switch or a relay is used.

Connection:

- Blue – GND / Minus
- Brown – open
- Black – close

ACTICLE №	FEATURE	MATERIAL
BEETLE 3V	Lock with 3V control	Die-cast zinc
BEETLE 12V	Lock with 12V control	Die-cast zinc

BEETLE BOLT

The BOLT versions of the BEETLE lock has a lengthened bolt. This is up to 3 mm beyond the case.

These versions are used for locks of drawer slides, central locking rods or hinges.

ACTICLE №	FEATURE	MATERIAL
BEETLE SECONDARY LOCK BOLT	Lock for combination with a SOLO as a group	Die-cast zinc
BEETLE 3V BOLT	Lock with 3V control	Die-cast zinc
BEETLE 12V BOLT	Lock with 12V control	Die-cast zinc

ACCESSORIES

Latch 74

The LATCH74 is used as a counterpart of the SOLO and TEN. It is mounted on the side of hinged doors, drawers or on the upper web of drawers.

- Adjustable in height / width / depth
- Automatic adjustment +/- 2 mm
- Ejector with 5,4 N spring force
- Breaking point of 25 kg

A handle-free opening of doors and light drawers without a tumbler is possible.

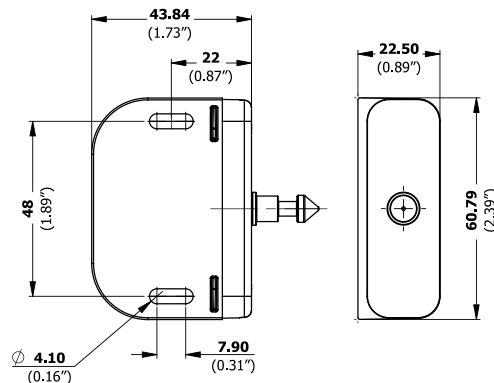

ACTICLE №	FEATURE	COLOUR
LATCH74	3D adjustable	Black

Latch 75

The LATCH75 is a frontal counterpart. It is mainly used for sliding doors in combination of the SOLO, TEN, and BEETLE or when the SOLO or BEETLE is mounted on the carcass of the furniture.

- Automatic adjustment +/- 2 mm
- Breaking point of 25 kg
- Adjustable in one direction when mounting

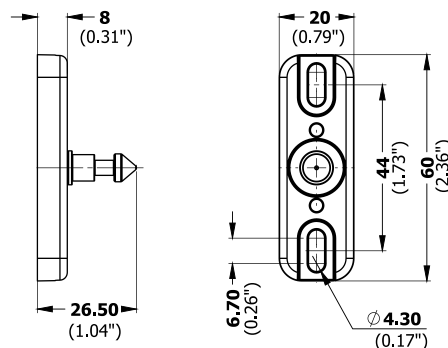

ACTICLE №	FEATURE	COLOUR
LATCH75	Locking part adjustable	Black

Latch FLIN

The FLIN locking part serves as a counterpart for the FLIN lock and is drilled into the inside of the door or drawer front.

It has a tolerance of 1.5mm.

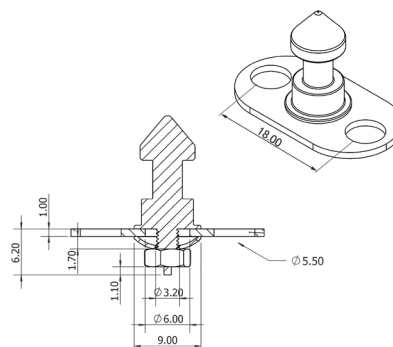

ACTICLE №	FEATURE:	COLOUR:
LATCH FLIN	Mini locking part for FLIN	Stainless steel

Glass mounting kit

The GLASSKIT is used for mounting on glass furniture in combination with the product family SOLO.

Breaking point:

- Up to 45 kg with hinged doors
- Up to 25 kg with sliding doors

The assembly takes place directly on the cleaned glass surface through the supplied adhesive tape. The cover film is attached to the outside.

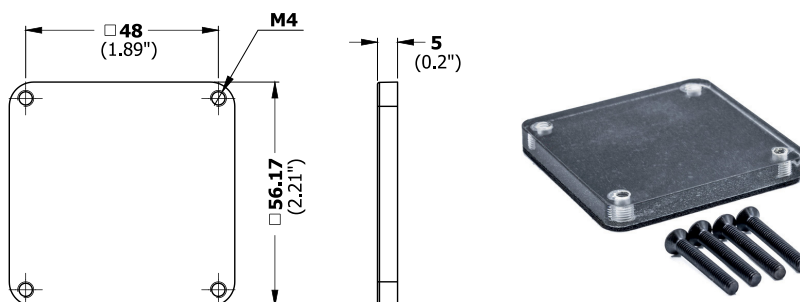

ACTICLE №	FEATURE	COLOUR
GLASSKIT	To fasten SOLO locks on glass	Black

Metal mounting kit

The METALKIT is used for mounting on metal furniture in combination with the product family SOLO.

- Punching out the metal: 42×42 cm

The supplied screws are suitable for metal thicknesses of 0,5-2 mm to screw the cover plate to the lock.

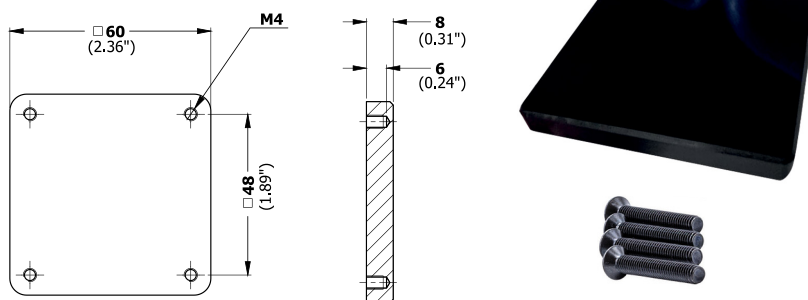

ACTICLE №	FEATURE	COLOUR
METALKIT	To fasten SOLO locks through metal doors	Black

Battery CR 123A

The BATTERY CR123A is used to power the electronic furniture locks of the following product families:

SOLO, TWO, TEN, PLUR, ONE and PAD.

When the end of the battery life is reached, a continuous tone of 15 seconds sounds when the furniture is opened, and the lock does not lock anymore.

The TEN lock shows a LED light signal and the lock does not lock after opening.

Do not use in combination with an external power supply.

Lifespan:

- 125 kHz: 5-9 years - 25.000 cycles
- 13,56 MHz: 4-6 years - 15.000 – 20.000 cycles
- Bluetooth: 3-4 years - 15.000 cycles

In continuous operation, a battery works up to 35 000 cycles. It is advisable to replace the battery every three years.

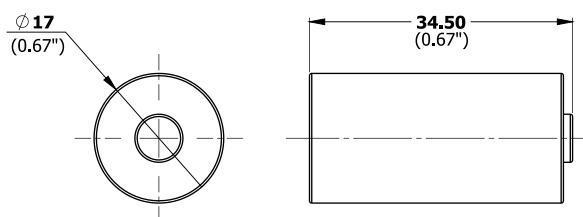

ACTICLE №	FEATURE	CAPACITY
BATTERY CR123A	Lithium metal battery	1600 mAh

Programming card

The programming card is used to activate and deactivate RFID keys.

- A programming card can be used for countless locks
- The programming card is activated by pressing the button on the back of the lock (see programming instructions)
- Only one programming card per lock can be active

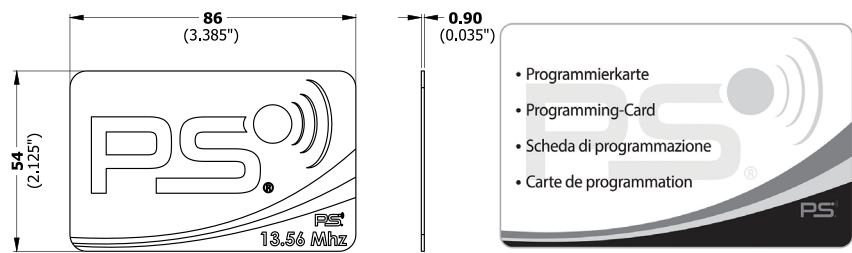

ACTICLE №	COMPATIBLE WITH	RANGE
PROCARD 125	All 125 kHz locks	< 35 mm
PROCARD 13	All 13,56 MHz locks	< 25 mm

Key card

The KEYCARD is used as a key for RFID locks.

- Water resistant
- Credit card format

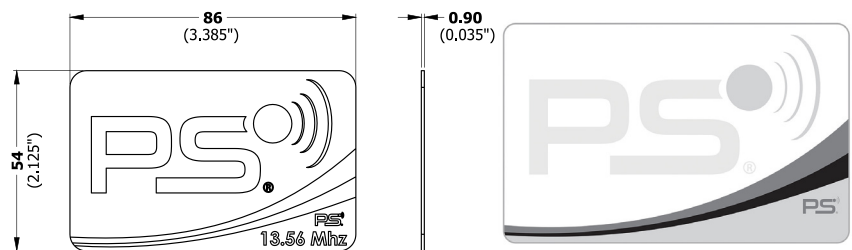

ACTICLE №	COMPATIBLE WITH	RANGE
KEYCARD 125	All 125 kHz locks	< 35 mm
KEYCARD 13	All 13,56 MHz locks	< 25 mm

Key fob D

This KEYFOB D is used as a key for 125 kHz locks.

- Water resistant
- Metal frame
- Colour: black and shiny

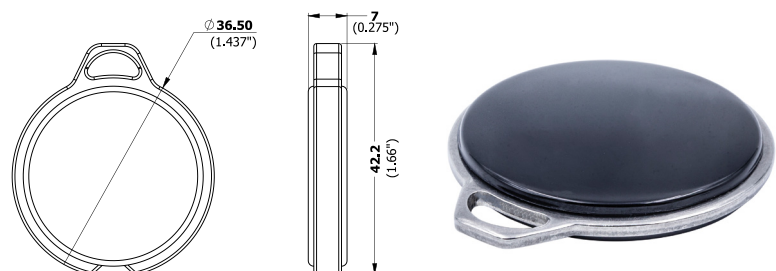

ACTICLE №	COMPATIBLE WITH	RANGE
KEYFOB 125 D	All 125 kHz locks	< 15 mm

Key fob

The KEYFOB is used as a key for RFID locks.

- Water resistant
- Colour: black and white

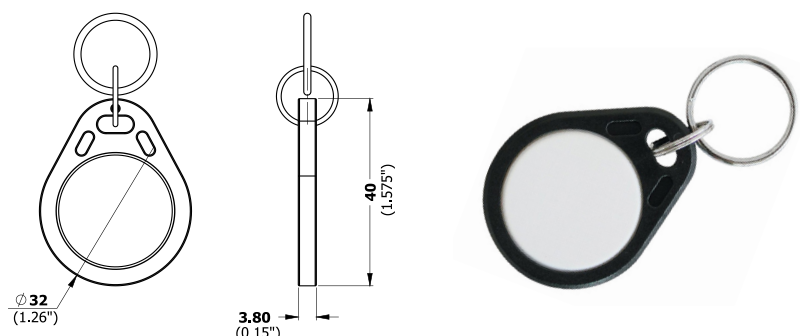

ACTICLE №	COMPATIBLE WITH	RANGE
KEYFOB 125	All 125 kHz locks	< 15 mm
KEYFOB 13	All 13,56 MHz locks	< 15 mm

RFID sticker

The KEYSTICKER 125 is used as a key for the 125 kHz locks. These RFID stickers can be attached to existing cards or HMI devices.

Features:

- Are particularly suitable for mounting on plastic
- 3M 0,3 mm thick adhesive film on the back
- Round version: 30 mm Ø
- Rectangular version: 30×19 mm
- Different sizes on request

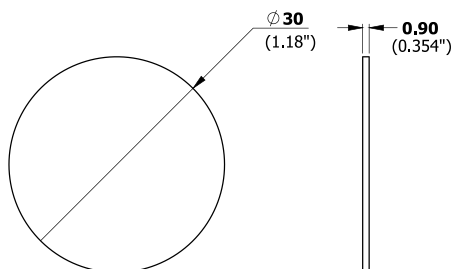

ACTICLE №	FEATURE	RANGE
KEYSTICKER 125 30x19	Compatible with 125 kHz locks, black mat	< 20 mm
KEYSTICKER 125 30W	Compatible with 125 kHz locks, round white	< 20 mm
KEYSTICKER 125 30S	Compatible with 125 kHz locks, round black	< 20 mm

External antenna 125

If the SOLO or PLUR lock with 125 kHz is difficult to access, this antenna is plugged into the lock to simplify the application.

- Wooden furniture: not visible from the outside, mounted on the inside
- Metal furniture: visible from the outside
- Cable length: 1,5 m
- EM4102 / EM4200 RFID technology

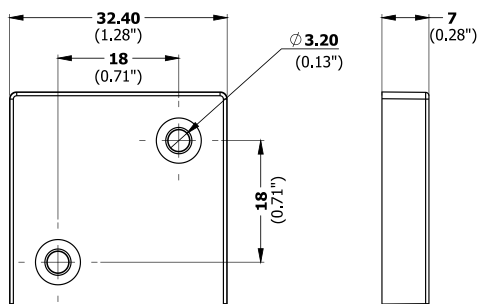

ACTICLE №	COMPATIBLE WITH	RANGE
ANTENNA 125	All 125 kHz locks	< 20 mm

Power bank

The power bank quadruples the battery capacity and thus reduces maintenance work. The power bank is inserted at the back of the SOLO lock and has the same size as the SOLO lock.

The three pieces of CR123A BATTERY are not included in the standard electronic SOLO product.



ACTICLE №	FEATURE:	SIZE:
POWERBANK	3x CR123A battery holder	60x60x22 mm

External power supply

The power supply is a direct power supply for the SOLO and PLUR lock and is connected with a 1,5m long cable at the back of the lock.

Features:

- EU plug 220V
- US plug 110V
- Do not use in combination with batteries
- Up to 5 connected locks can be operated with one transformer

In combination with the SOLO lock, a spacer plate is suitable.

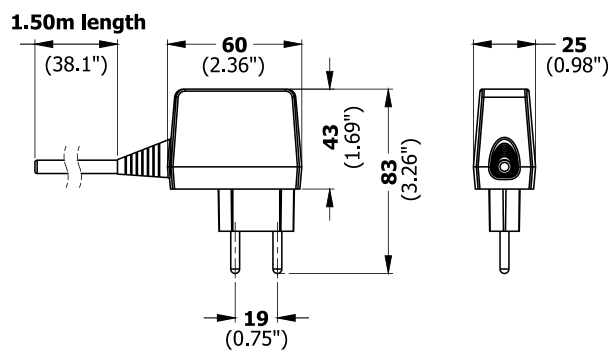

ACTICLE №	COMPATIBLE WITH	PLUG
PSUPPLY 125	SOLO 125, SOLO BT, PLUR 125, PLUR BT	EU
PSUPPLY 13	SOLO 13, PLUR 13	EU
PSUPPLY 125 US	SOLO 125, SOLO BT, PLUR 125, PLUR BT	US
PSUPPLY 13 US	SOLO 13, PLUR 13	US

Spacer plate

The spacer plate protects the cables when a SOLO is used with a transformer, SOLO SECONDARY LOCK or external antenna.

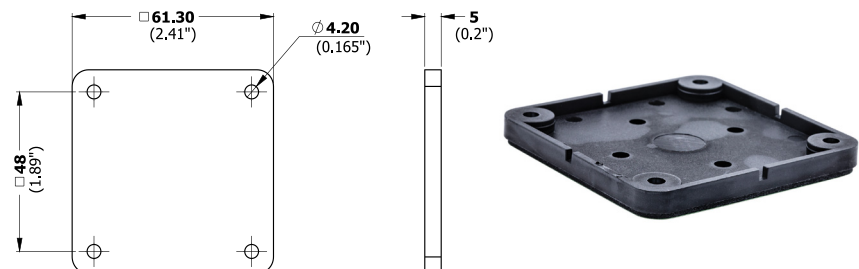

ACTICLE №	COMPATIBLE WITH	COLOUR
DISTANCEPLATE	SOLO	Black

Connection cable

The connection cable serves as a connection between SOLO and SOLO SECONDARY LOCKS.

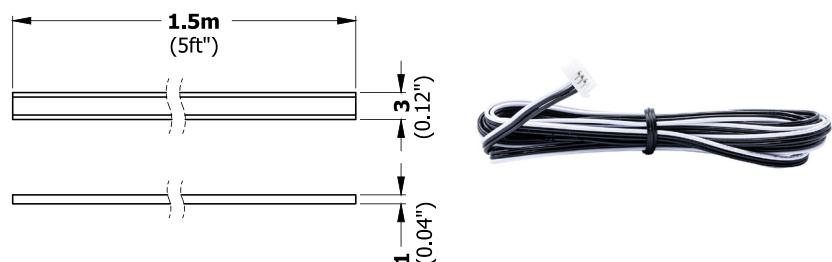

SOLO	COMPATIBLE WITH	CABLE LENGTH
CONCABLE 1.5	SOLO, PLUR	1,5 m (60")
CONCABLE 3	SOLO, PLUR	3 m (120")
CONCABLE 5	SOLO, PLUR	5 m (195")
CONCABLE 10	SOLO, PLUR	10 m (390")

Battery AAA

The BATTERIES AAA are used to power the GYM or the QUAD furniture locks.

When the end of battery life is reached, a continuous tone of 15 seconds sounds when the furniture is opened. The lock does not lock anymore from that moment on.

Lifespan:

- 125 kHz: 5-9 years - 25.000 cycles
- 13,56 MHz: 4-6 years - 15.000 cycles
- Bluetooth: 3-4 years - 15.000 cycles

In continuous operation, the batteries work up to 25 000 cycles.

It is advisable to change the batteries every three years.

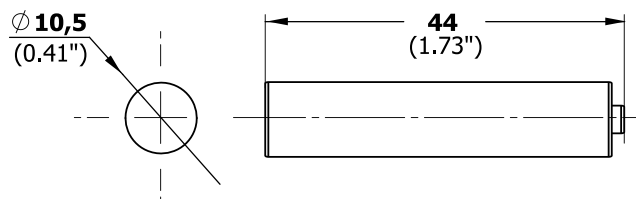

ACTICLE №	FEATURE	CAPACITY
BATTERY AAA	Lithium Ion Battery	1250 mAh

Latch 70

The LATCH70 serves as a mini counterpart for the BEETLE lock. It is mostly used in glass showcases or in very small drawers.

- The closing part has no tolerances which is why a very precise processing of the furniture is necessary
- UV adhesive glue is suitable for attachment to the glass. This is not included

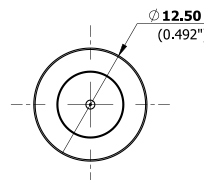
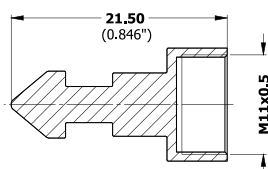

ACTICLE №	FEATURE	COLOUR
LATCH70	Mini locking part	Stainless steel

Extension board

The plug-in distributor is a slot extension in applications such as the SOLO with SOLO SECONDARY LOCKS. It is also used when several BEETLE SECONDARY LOCKS are operated together.

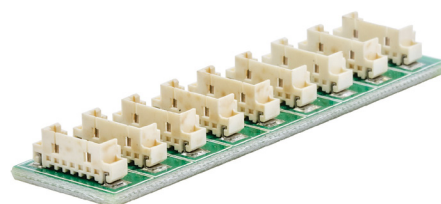
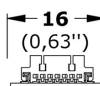
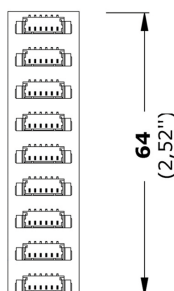

ACTICLE №	COMPATIBLE WITH	SLOTS
EXTENSION BOARD	SOLO, BEETLE	9

Quad locking part

In most applications, the bolt from the QUAD locks directly into the furniture's frame.

With this locking part, you can use the QUAD on even surfaces. The integrated spring bolt opens the door automatically.

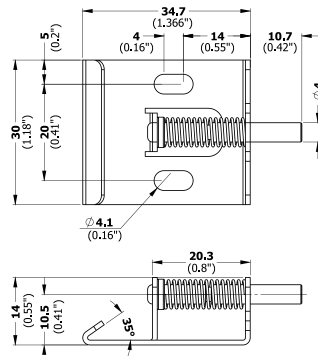

ACTICLE №	COMPATIBLE WITH	COLOUR
QUAD-LATCH	QUAD	Black

Update: Gym

With the free locker choice, you can occupy lockers with your RFID key to any unused cabinet. Only that key or the programming card can reopen this cabinet. After opening, the cabinet can be occupied by any other keys.

Features:

- Ideal for use in public areas, gyms or staff cabinets
- The cabinet can only be occupied when the door is closed
- With one card several cabinets can be occupied
- The lock does not need writing permission on the map
- Only the UID number of the card is read
- When not installed, the lock can be tested with the locking part inserted

ACTICLE №	COMPATIBLE WITH	AUTOMATIC OPENING
UPDATE GYM	SOLO 125 +, SOLO 13 +	Never
UPDATE GYM 12h	SOLO 125 +, SOLO 13 +	After 12 hours

Update: Alarm

If the furniture is not closed within 25 seconds, a continuous tone sounds as an alarm.

Applications:

- Ideal for securing merchandise in shops
- Securing medicines and spirits

The alarm can be deactivated by active RFID key or closing the door.

ACTICLE №	COMPATIBLE WITH	ALARM
UPDATE ALARM	SOLO 125+, SOLO 13+	Ticking noise

Update: Bolt

With this update, the lock does not lock automatically after 3 seconds but remains open until the key is held on again.

When using several locks in a group (wired), this function may only be used with an external power supply.

ACTICLE №	COMPATIBLE WITH	FREQUENCIES
UPDATE BOLT	SOLO, PLUR, TWO	125 kHz; 13,56 MHz

PROGRAMMING

RFID Activating the programming card

Before mounting

1. Press the white button in the middle on the back side of the lock.
2. The lock will make a ticking sound (signal). Place the card to the lock within 3 seconds during the signal.
3. Two short ascending tones will confirm that the programming card has been saved successfully.

Initializing a key

Initializing the key card or chip key.

1. Please place the programming card onto the lock.
2. The lock will make a ticking sound (signal). Place the key card or chip key onto the lock within 3 seconds of hearing this signal.
3. Two short ascending tones will confirm that initialization was successful. The lock can now be opened using the key card or the chip key.

TIP:

A maximum of 49 different keys can be initialized.

Deleting the key card or chip key

Key access denied

1. Please place the programming card onto the lock.
2. The lock will make a ticking sound (signal). Place the key card or chip key onto the lock within 3 seconds of hearing this signal.
3. Four short sounds confirm that the key has been deleted.

Deleting all keys:

You can delete all keys at once by holding the programming card to the lock for 15-20 seconds until a long signal appears as confirmation.

Bluetooth features of the PS app

Installation

1. Download the "PSLocks" app from the Apple Store | Google Play Store.
2. When the app is downloaded and opened for the first time, a short introduction of the most important content is displayed - for example: Searching for locks | Battery status | Opening and closing, etc.
3. In the next step you can enter your name to be displayed.
4. Then the app searches for locks nearby - all locks within the range will be displayed.
5. When you click on the grey lock icon that is displayed you will be prompted to enter a code, this is by default "1234" and can be changed by the administrator.
6. After entering this code, the lock symbol turns green and is now ready for use.
7. The battery status is displayed, as well as the status of whether the lock or the door is opened or closed.



Application

1. Click the lock icon to open or close the lock.
2. Clicking on the name of the lock takes you to the details page of the lock.
3. The history of the locks openings and closings is displayed here. The date | time | name | lock status is displayed. In addition, the battery charge is indicated in percentage and volts.
4. In the upper right corner you can find the symbol for settings. by clicking on it, the administrator code is required - this is "123456" by default but can of course also be changed in  the administrator field.

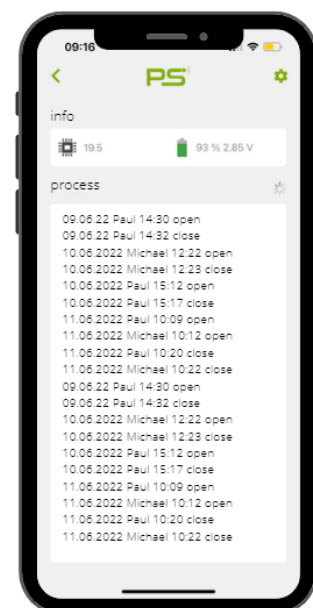

About Us

SOLO

TEN

TWO

PLUR

QUAD

MINI

FLIN

PAD II

BEETLE

Accessories

Programming

Administration

1. In the lock settings (top right corner, when you click on the lock name) you need the 6-digit administrator pin.
2. On this page you can change some settings of the lock.
3. For your own safety we recommend to change the code immediately.
4. If the administrator code has been forgotten, you can reset the lock with the reset button on the backside of the lock. The codes are again set to Standard User| 1234 and Administrator | 123456.
5. Locking delay: here you can adjust how many seconds after opening the lock closes automatically. If the slider is moved all the way to the right, then the lock is in BOLT state and will not close until you click the lock symbol again.
6. The battery alarm slider can be used to select between mains operation, battery or padlock. (only with IOS)

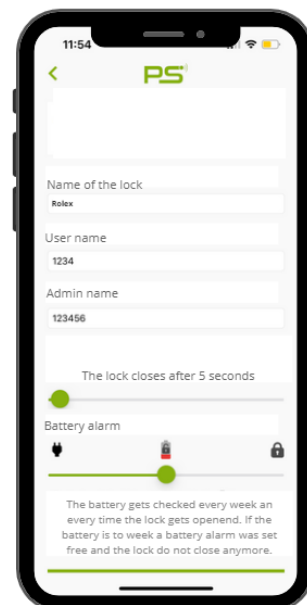

Battery-Alarm

1. If the battery has reached a critical state, this message will appear before the lock opens.
2. Please change the battery immediately.
3. You can still open the lock by clicking OK.
4. If you ignore this message, the battery will discharge completely and the lock will remain closed. In this case, the lock must be openend with force - use the widest possible flat piece of metal or Suction lifter (for glass transport) for this purpose.

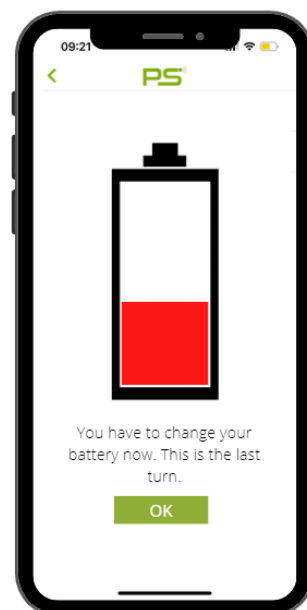

Firmware update

1. If you have an old lock, you will see a red Update firmware - this process takes about 25 seconds.

Groups of locks

1. In the latest version of the app, up to 5 locks can be connected to form a group. This allows to open more than one lock at the same time.
2. To do this, press the icon in the top right corner on the main page. 
3. All locks within the range are displayed in an overview.
4. Click on the locks that should be added to the group.
5. Then click on SELECT and the group will be created. 1.



PS GmbH
 Melisau 1255
 6863 Egg / Austria
 FN 326841 z / ATU64996348
 info@pslocks.com
 www.pslocks.com

 SUPPORT +43 699 1333 5155

CE FC